

# Highland Cemetery

SEC. 1 BLK. 100 LOT \_\_\_\_\_ SIZE \_\_\_\_\_

INTERMENTS		
NO.	NAME	DATE
1		
2		
3		
4	Howell, Laura Cecil (b. 22 Feb 1859)	21 Feb 1921 23 Feb 1921
5		
6		
7		
8		
9		
10		
11		
12		

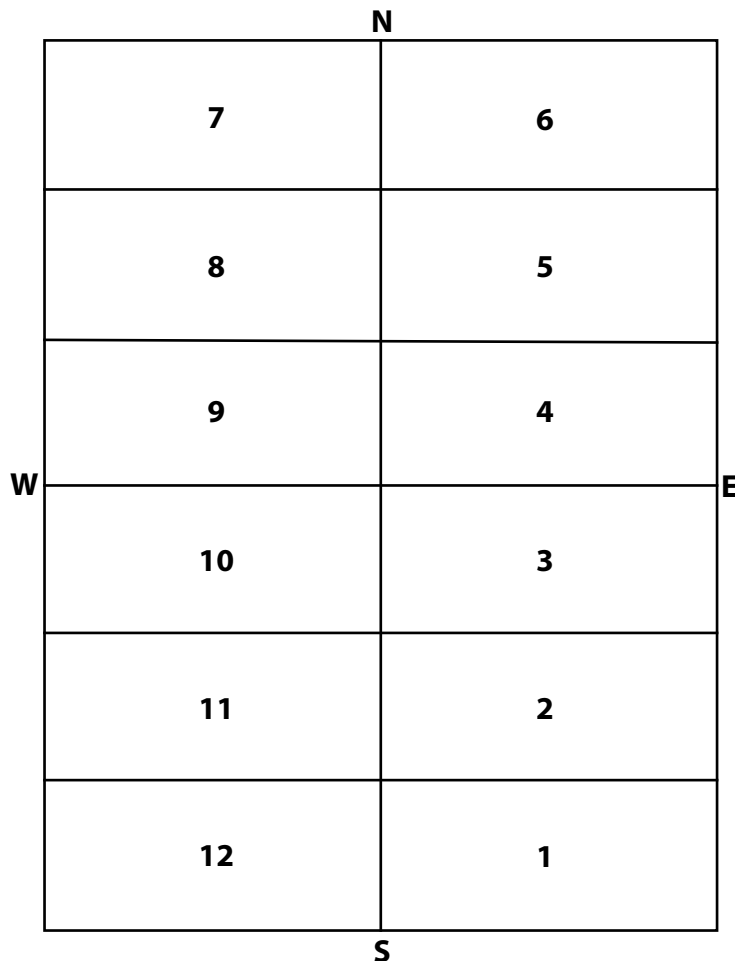

**OWNER** Patterson, P.A.  
Res. Genevieve Wilbur  
Res. Dorothy Schwartz

# Highland Cemetery

SEC. 1 BLK. 101 LOT \_\_\_\_\_ SIZE \_\_\_\_\_

INTERMENTS		
NO.	NAME	DATE
1	Bullinger, John Matthew (b. 13 Nov 1826)	14 Jan 1908 15 Jan 1908
2	Bullinger, Lydia Catherine (b. 1833)	1916 17 Apr 1916
3		
4	Maxson, William H. (b. ????)	???? 23 Jun 1921
5		
6	Maxson, Barbara Bullinger (b. 1856)	1887 16 Mar 1887
7		
8	Bullinger, James E. (b. )	???? 8 May 1922
9		
10		
11	Maxson, William Ray (b. ????)	???? 25 Feb 1939
12	Peck, Sarah A. (b. ????)	???? 25 Apr 1927

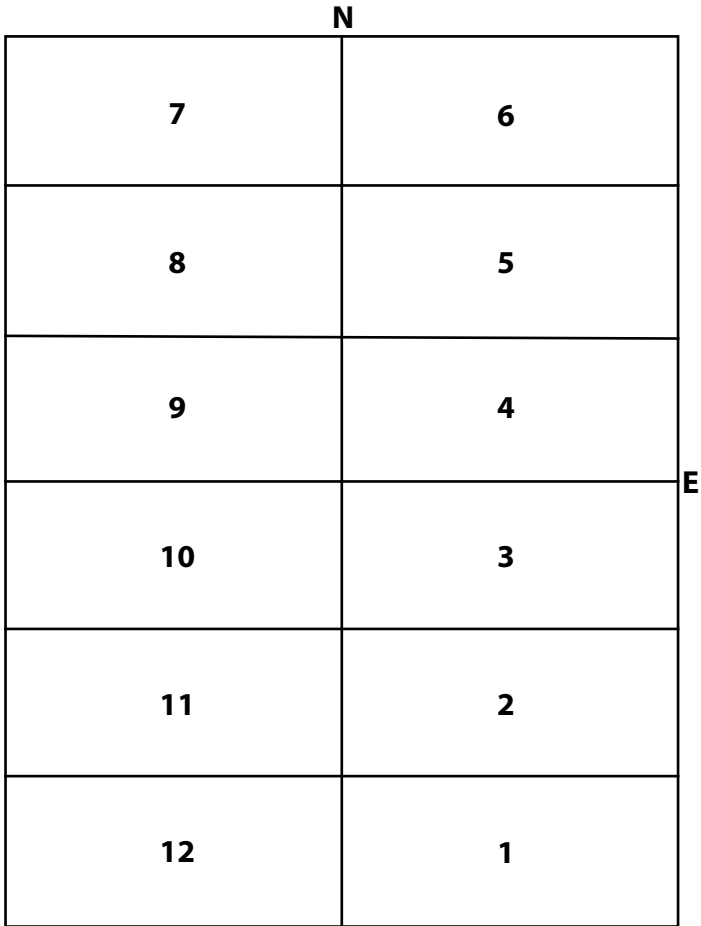

**OWNER** Bullinger, John M.  
\_\_\_\_\_  
\_\_\_\_\_  
\_\_\_\_\_

# Highland Cemetery

SEC. 1 BLK. 102 LOT \_\_\_\_\_ SIZE \_\_\_\_\_

## INTERMENTS

NO.	NAME	DATE
1		
2		
3		
4		
5		
6		
7	<i>Thomas, Sarah Elizabeth (b. 1 Jan 1854)</i>	<i>16 Sep 1935 18 Sep 1935</i>
8	<i>Thomas, Joseph Frank (b. 16 May 1840)</i>	<i>2 Apr 1919 4 Apr 1919</i>
9		
10	<i>Thomas, William L. (b. 3 Apr 1817)</i>	<i>5 Jul 1899 6 Jul 1899</i>
11		
12	<i>Thomas, Susan Alice (b. 1859)</i>	<i>31 Aug 1877 Sep 1877</i>

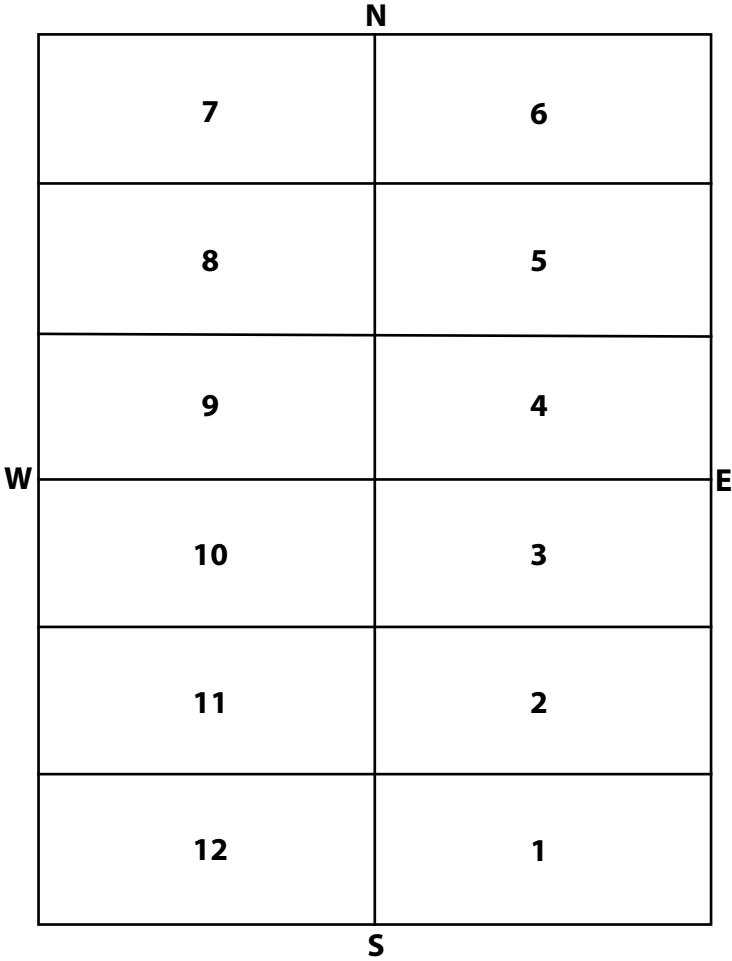

**OWNER** Thomas, W.L.

---



---



---

# Highland Cemetery

SEC. 1 BLK. 103 LOT \_\_\_\_\_ SIZE \_\_\_\_\_

INTERMENTS		
NO.	NAME	DATE
1		
2	Garrison, Charles M. (b. 1836)	20 Jul 1918 22 Jul 1918
3	Garrison, Carrie (b. ?????)	???? 23 May 1941
4	Garrison, Sarah M. (b. 1847)	12 May 1884 12 May 1884
5	Holmes, George (b. ?????)	???? 15 Jun 1930
6	Whitton, Gertrude H. (b. ?????)	???? 14 Jan 1937
7	Hartman, Doris E. (b. 5 Sep 1903)	19 Apr 1983 22 Apr 1983
8	Hartman, Evan Harris (b. 5 Sep 1903)	22 May 1978 24 May 1978
9		
10		
11		
12	Davis, Infant of P. (b. ?????)	???? 7 Jun 1909

	N
7	6
8	5
9	4
10	3
11	2
12	1
	S

OWNER Garrison, C.M.

---



---



---

# Highland Cemetery

SEC. 1 BLK. 104 LOT \_\_\_\_\_ SIZE \_\_\_\_\_

INTERMENTS		
NO.	NAME	DATE
1		
2		
3		
4		
5		
6	Mason, Jessie (b. 1895)	14 Aug 1876
7		
8		
9		
10		
11		
12		

		N	
	7		6
	8		5
	9		4
W			E
	10		3
	11		2
	12		1
		S	

**OWNER** #1-3, 10-12: Thomas, H.B. S 1/2 (30 Sep 1878) Book B, p. 18  
 #4-6: Mason, William NE 1/4  
 #7-9: Bates, S. NE 1/4 (18 Oct 1878) Book B, p. 18

# Highland Cemetery

SEC. 1 BLK. 105 LOT \_\_\_\_\_ SIZE \_\_\_\_\_

## INTERMENTS

NO.	NAME	DATE
1		
2		
3		
4		
5		
6		
7		
8		
9		
10		
11		
12		

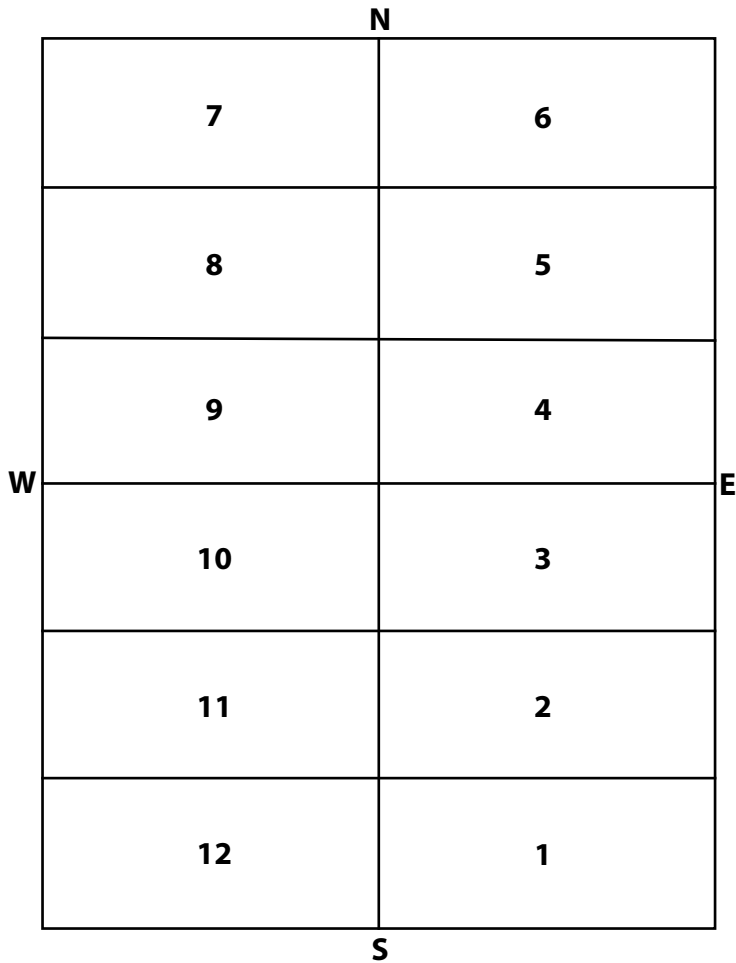

OWNER Linder, Dr. (7 Feb 1878) Book B, p. 18

---

---

---

# Highland Cemetery

SEC. 1 BLK. 106 LOT \_\_\_\_\_ SIZE \_\_\_\_\_

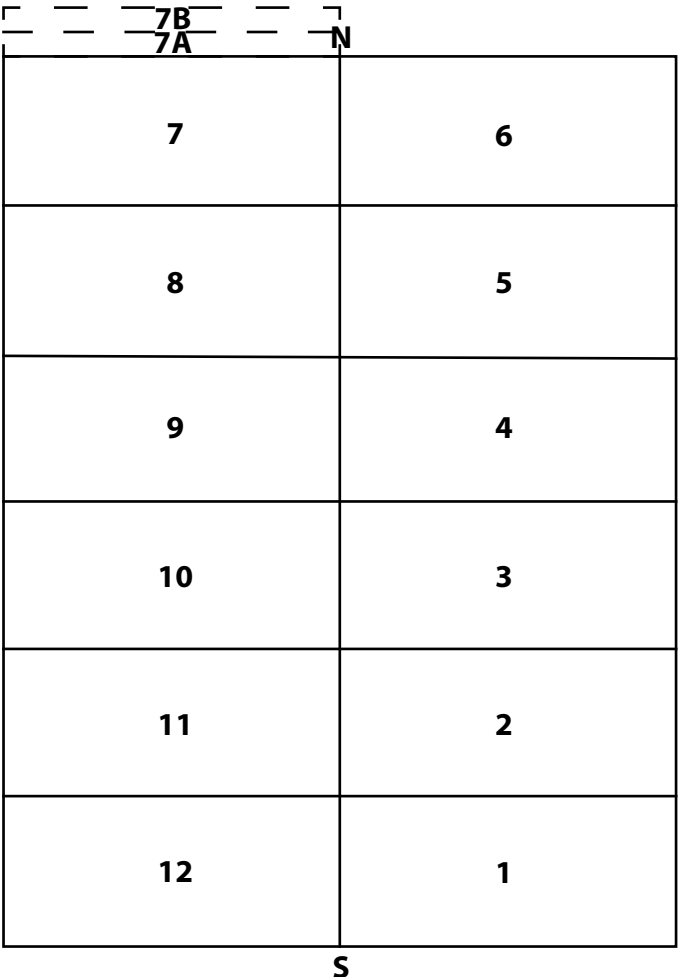

INTERMENTS		
NO.	NAME	DATE
1	Drier, Henry (b. ????)	???? 1878
2	Reynolds, Russell H. (b. ????)	8 Jan 1889 8 Jan 1889
3	Drier, Birtie (b. ????)	???? 24 Nov 1879
4		
5		
6		
7	Thornton, Flora B. (b. 1874)	16 Nov 1878 16 Nov 1878
7A	Basom, Donald T. (b. 16 Apr 1907)	21 May 1963 24 May 1963
7B	Basom, Marie E. (b. 3 May 1907)	18 Sep 1995 21 Sep 1995
8		
9		
10		
11	Cornelison, Elizabeth D. (b. 1856)	9 Aug 1921 11 Aug 1921
12	Drier, Harry (b. 26 Jan 1829)	28 May 1917 31 May 1917

**OWNER #1-3, 10-12: Drier, Henry S 1/2**  
 #4-9: Thornton, W.H. N 1/2  
 #7A-7B: Basom (24 Jun 1963)

# Highland Cemetery

SEC. 1 BLK. 107 LOT \_\_\_\_\_ SIZE \_\_\_\_\_

INTERMENTS		
NO.	NAME	DATE
1	Donnell, James T. (b. 28 Jan 1862)	5 May 1936 7 May 1936
2	Donnell, Gertrude Hoskins (b. 24 May 1862)	6 May 1919 8 May 1919
3	Farmer, Eugene (b. 16 Dec 1884) - ashes	Aug 1965 3 Sep 1965
3	Farmer, Laura Donnell (b. 1886)	21 Jan 1972 24 Jan 1972
4	Ward, Rufus (b. 8 Jul 1872)	18 Jun 1940 20 Jun 1940
5	Ward, Frances M. (b. 10 May 1882)	11 Feb 1960 12 Feb 1960
6		
7	Scott, Katherine J. (b. 10 Apr 1837)	24 Jan 1914 25 Jan 1914
8	Scott, Charles W. (b. 1828)	1921 1921
9	Scott, Lena R. (b. 2 Mar 1870)	15 Apr 1939 19 Apr 1939
10	Paxson, Amos C. (b. 8 Nov 1812)	3 Jan 1908 25 Jun 1910
11	Singer, Melvina Amanda (b. 26 Jan 1838)	9 Aug 1921 11 Aug 1921
12	Donnell, Muriel (b. ????)	1953 1953
12	Donnell, William Clarence (b. 6 Sep 1884) - cremains	Dec 1970 15 Dec 1970

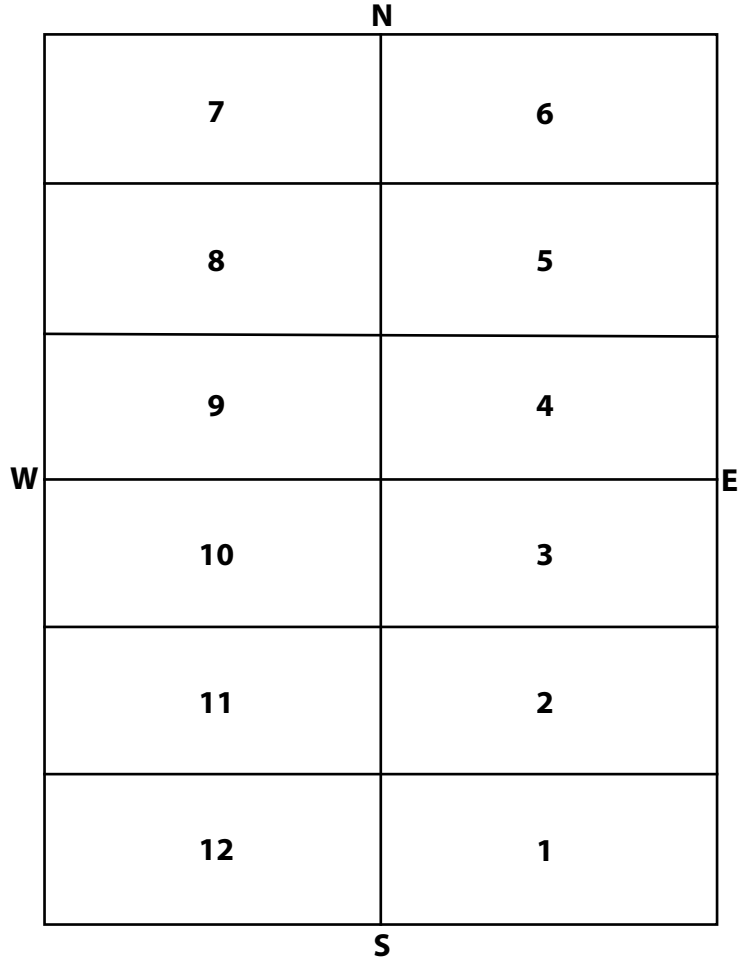

**OWNER** #1-3, 10-12: Singer, I.N. & Donnell, J.T. S 1/2  
 #4-6: Ward, Frances NE 1/4 from Scott, Lena  
 #7-9: Scott, Lena NW 1/4  
 #10: Amos C. Paxton removed from Sec. 1, Lot 157.  
 #12: Isaac Newton Singer removed to Park Cemetery.



# Highland Cemetery

SEC.   1   BLK.   108   LOT            SIZE           

<b>INTERMENTS</b>		
<b>NO.</b>	<b>NAME</b>	<b>DATE</b>
1		
2		
3	<i>Parks, Dan Franklin (b. 10 Nov 1840)</i>	<i>29 Jan 1930 31 Jan 1930</i>
4	<i>Parks, Sardenia E. (b. ?????)</i>	<i>12 Oct 1915 13 Oct 1915</i>
5	<i>Parks, Harry Franklin (b. 15 Jun 1873)</i>	<i>23 Apr 1915 26 Apr 1915</i>
6		
7		
8		
9		
10		
11		
12		

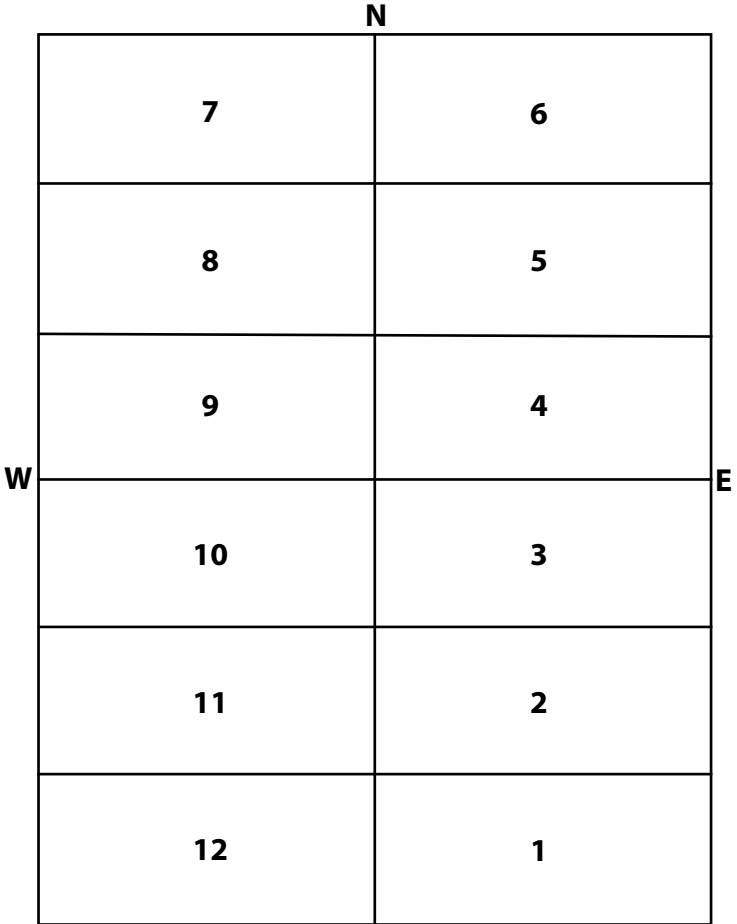

S

**OWNER** *Parks, Dan F.*

\_\_\_\_\_

\_\_\_\_\_

\_\_\_\_\_

# Highland Cemetery

SEC.   1   BLK.  109  LOT \_\_\_\_\_ SIZE \_\_\_\_\_

INTERMENTS		
NO.	NAME	DATE
1	<i>Root, Elisha (b. 18 Jan 1856)</i>	<i>22 Apr 1914 25 Apr 1914</i>
2	<i>Root, Ella (b. 1858)</i>	<i>1954 2 Aug 1954</i>
3	<i>Root, Selah E. (b. 1 Mar 1887)</i>	<i>25 Dec 1959 28 Dec 1959</i>
4	<i>Baker, Ella L. (b. ????)</i>	<i>21 Mar 1914 23 Mar 1914</i>
5		
6	<i>Richards, William Cooper (b. ????)</i>	<i>28 Dec 1913 29 Dec 1913</i>
7	<i>Shank, Blanche Leona (b. 16 Aug 1891)</i>	<i>12 Jan 1914 13 Jan 1914</i>
8	<i>Burk, Dorothy Caroline Cox (b. 17 Dec 1913)</i>	<i>7 Jul 1983 8 Jul 1983</i>
9	<i>Cox, Guy R. (b. 7 Sep 1900)</i>	<i>22 Oct 1970 26 Oct 1970</i>
10		
11	<i>Herbig, Infant (b. ????)</i>	<i>28 Jun 1893 1893</i>
12	<i>Herbig, Edna Louise (b. 12 Nov 1882)</i>	<i>22 Apr 1892 22 Apr 1892</i>

**N**

7	6
8	5
9	4
10	3
11	2
12	1

**W**
**E**

**S**

- OWNER #1-3:** Root, Mrs. Ellen SE 1/4
- #4-6:** Baker, Mrs. Ella NE 1/4
- #7-9:** Shank, O.E. NW 1/4
- #10-12:** Herbig, W.H. SW 1/4

# Highland Cemetery

SEC. 1 BLK. 110 LOT \_\_\_\_\_ SIZE \_\_\_\_\_

## INTERMENTS

NO.	NAME	DATE
1	Martin, Neal Dow (b. 23 Feb 1881)	19 Feb 1920 19 Feb 1920
2		
3		
4		
5		
6		
7	Beard, Edward F. (b. ????)	4 Nov 1873 1873
8	Beard, Deborah M. (b. 24 Jan 1830)	26 Apr 1906 28 Apr 1906
9		
10		
11		
12		

	N		
	7	6	
	8	5	
	9	4	
W	10	3	E
	11	2	
	12	1	
	S		

OWNER Beard, E.T.

---



---



---

# Highland Cemetery

SEC. 1 BLK. 111 LOT \_\_\_\_\_ SIZE \_\_\_\_\_

## INTERMENTS

NO.	NAME	DATE
1		
2		
3		
4		
5	<i>Vannoy, Ellen (b. 13 Jun 1852)</i>	<i>11 Apr 1877 11 Apr 1877</i>
6		
7		
8	<i>Fuller, De Forrest (b. 12 Jul 1866)</i>	<i>12 Feb 1877 12 Feb 1877</i>
9		
10		
11	<i>Iseminger, George (b. 1 Oct 1815)</i>	<i>11 Oct 1891 11 Oct 1891</i>
12	<i>Iseminger, Ada (b. 6 Aug 1896)</i>	<i>6 Jul 1898 6 Jul 1898</i>

N	
7	6
8	5
9	4
10	3
11	2
12	1
S	

OWNER #1-3, 10-12: *Iseminger, John George S 1/2*  
 #4-6: *Williams, G. NE 1/4*  
 #7-9: *Kellogg, S.J. NW 1/4*

# Highland Cemetery

SEC. 1 BLK. 112 LOT \_\_\_\_\_ SIZE \_\_\_\_\_

INTERMENTS		
NO.	NAME	DATE
1	Drake, Erwin L. (b. 1843)	1927 29 Apr 1927
1A	Res - Haines	
1B	Haines, Earl Cary "Jack" (b. 11 May 1927)	6 Sep 1991 9 Sep 1991
2	Drake, Etta (b. 1847)	1930 29 Aug 1930
3		
4	Sallee, Glen M. (b. 4 Jun 1910)	23 Oct 1973 26 Oct 1973
5	Sallee, Alva (b. 2 Sep 1876)	12 Nov 1924 14 Nov 1924
6	Sallee, Leta Minton (b. 14 Jun 1883)	10 Jan 1982 13 Jan 1982
7		
8		
9		
10		
11	James, Mary Catheryn (b. 15 Nov 1952)	30 Mar 1925 1 Apr 1925
12	James, J. Walter (b. 14 Jul 1850)	7 Jan 1925 10 Jan 1925
12A	Res - Clemence	
12B	Res - Clemence	

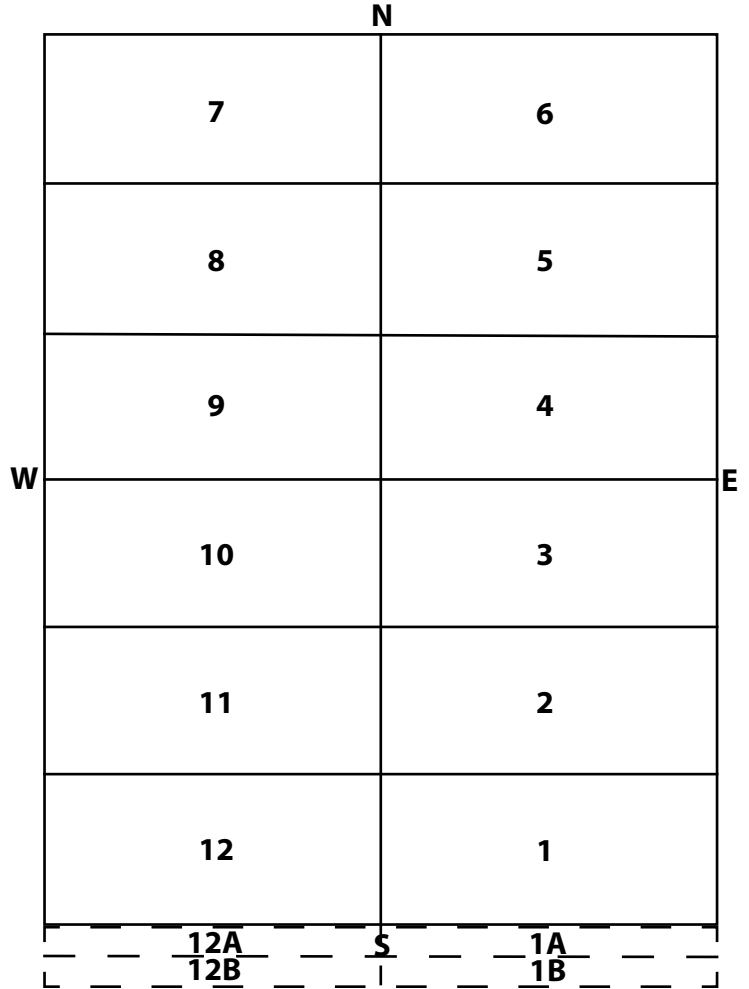

**OWNER** #1A-B: Haines, Earl C. Jr. 1637 Fabrique  
 #1-3: Drake, E.L. SE 1/4  
 #4-9: Sallee, Leta M. N 1/2 & Smythe, Charles H.  
 #10-12: James, J.W. SW 1/4  
 #12A-B: Clemence, Don K. & Marguerite (30 Nov 1977) 426 S. Sheridan

# Highland Cemetery

SEC. 1 BLK. 113 LOT \_\_\_\_\_ SIZE \_\_\_\_\_

**INTERMENTS**

NO.	NAME	DATE
1		
2	Bilderback, Franney (b. ?????)	???? 20 Jul 1876
3		
4		
5	Morgan, Willis M. (b. 15 Aug 1872)	18 Jun 1918 20 Jun 1918
6	Morgan, Bessie Florence L. (b. 31 May 1882)	24 Dec 1933 27 Dec 1933
7		
8	VanScyoc, Betty Long (b. 1918)	1922 8 Jun 1922
9	VanScyoc, Lawrence R. (b. 1895)	1918 1918
10		
11		
12		

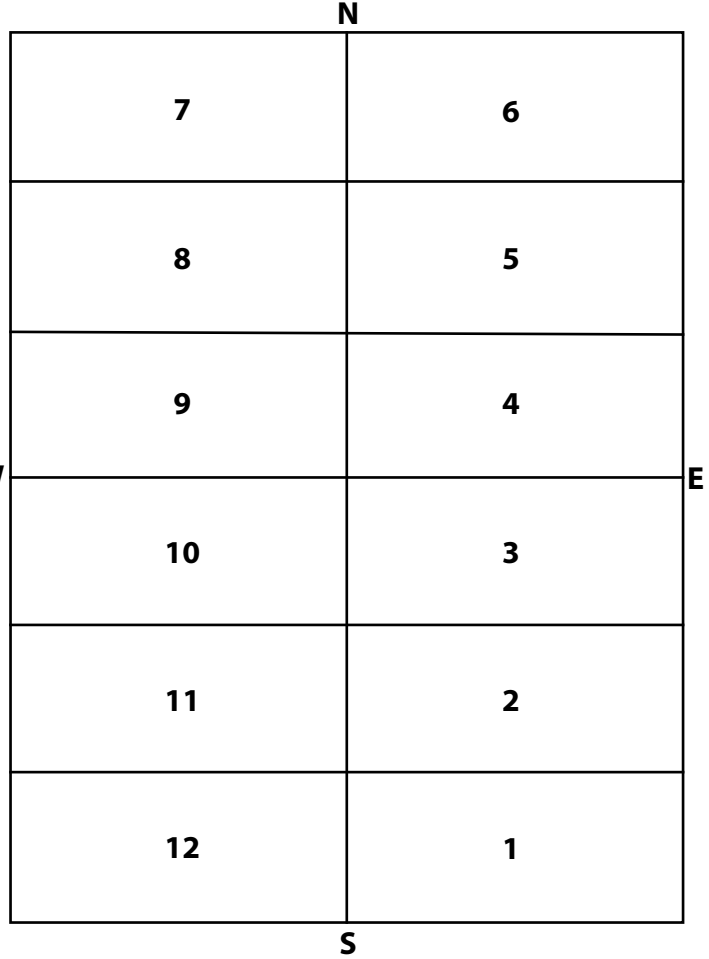

OWNER Single graves  
\_\_\_\_\_  
\_\_\_\_\_  
\_\_\_\_\_  
\_\_\_\_\_

# Highland Cemetery

SEC. 1 BLK. 114 LOT \_\_\_\_\_ SIZE \_\_\_\_\_

INTERMENTS		
NO.	NAME	DATE
1		
2	Marlow, Joe (b. 22 Oct 1888)	4 Aug 1967 7 Aug 1967
3	Marlow, Anna R. (b. 5 Nov 1893)	4 Jan 1970 7 Jan 1970
4	McDaniels, John (b. 1867)	1890 1890
5	Shepherd, Martha Margaret (b. 14 Dec 1870)	6 May 1912 13 May 1912
6		
7	Shepherd, Alfred (b. 1850)	1932 17 Aug 1932
7A	Shepherd, Laura O. (b. 1857)	1941 21 Oct 1941
8	Shepherd, Louise (b. 1877)	1879 1879
9	Gowing, Paul A. (b. 6 Sep 1884)	30 Apr 1919 3 May 1919
10	Marlowe, Tuisco (b. 1821)	5 Aug 1879 5 Aug 1879
11	Marlowe, Violetta (b. 1819)	7 Aug 1887 7 Aug 1887
12		

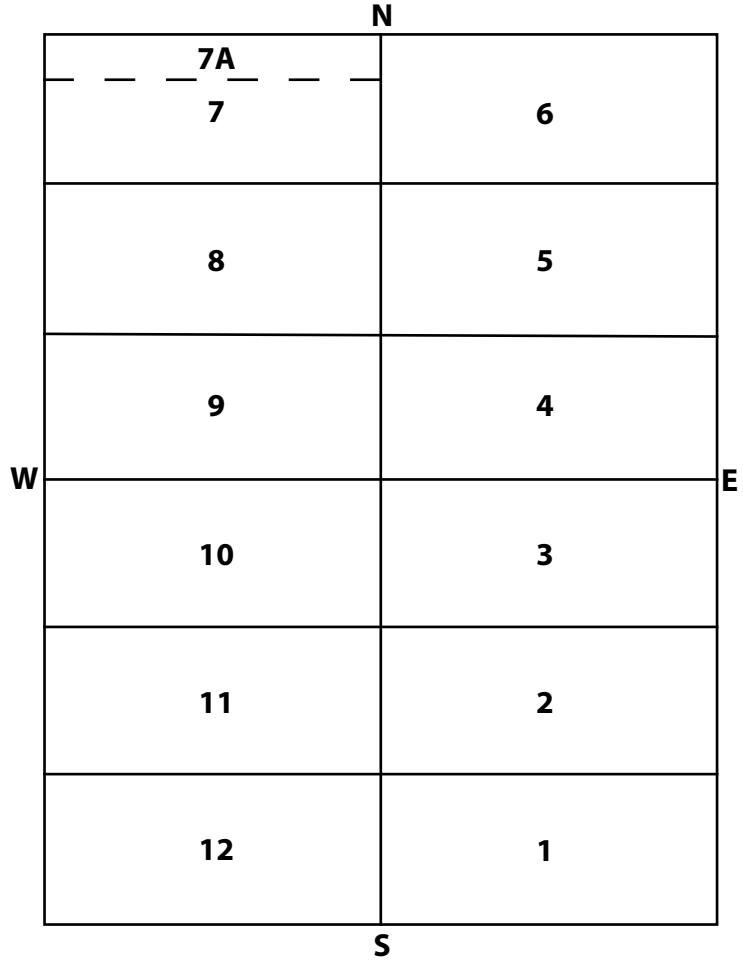

**OWNER** #1, 10-12: Marlowe, Mrs. W. S 1/2

---

#2-3: Marlow, Joe & Ann

---

#4-9: Shepherd, A. N 1/2

---





# Highland Cemetery

SEC. 1 BLK. 116 LOT \_\_\_\_\_ SIZE \_\_\_\_\_

## INTERMENTS

NO.	NAME	DATE
1		
2		
3	Shinn, Miles J. (b. ????)	27 Sep 1896 25 Sep 1896
4		
5	Shinn, Newman H. (b. ????)	???? 9 Mar 1923
6	Shinn, Alice (b. ????)	???? ????
7		
8		
9		
10		
11		
12		

N	
7	6
8	5
9	4
10	3
11	2
12	1

W E

S

OWNER Shinn, N.H.

\_\_\_\_\_  
\_\_\_\_\_  
\_\_\_\_\_

# Highland Cemetery

SEC. 1 BLK. 117 LOT \_\_\_\_\_ SIZE \_\_\_\_\_

INTERMENTS		
NO.	NAME	DATE
1	Henderson, Marian L. (b. ????)	???? 26 Nov 1938
1A	Brown, Frank (b. 22 Feb 1889)	22 Dec 1961 26 Dec 1961
1B	Brown, Ethel E. (b. 19 Apr 1892)	19 Apr 1987 21 Apr 1987
2	Brown, Lon Ben (b. 16 Jul 1891)	24 Nov 1959 27 Nov 1959
3	Brown, Hazel Olive (b. 6 Nov 1903)	12 Jul 1985 15 Jul 1985
4	Moore, Elmer (b. 22 Mar 1904)	14 Jul 1904 15 Jul 1904
5	Moore, Ophelia (b. 22 May 1900)	28 Jul 1900 29 Jul 1900
6	Clark, Infant (b. ????)	???? ????
7	Clark, Emma Moore (b. 1871)	24 Apr 1892 25 Apr 1892
8	Boyles, Lillian A. (b. ????)	22 Oct 1892 May 1892
9	Moore, Martha (b. 1829)	11 May 1894 1894
10		
11	Moore, George W. (b. 1830)	1924 12 Sep 1924
12	Godsey, Dorothy Parker (b. ????)	???? 16 Oct 1952

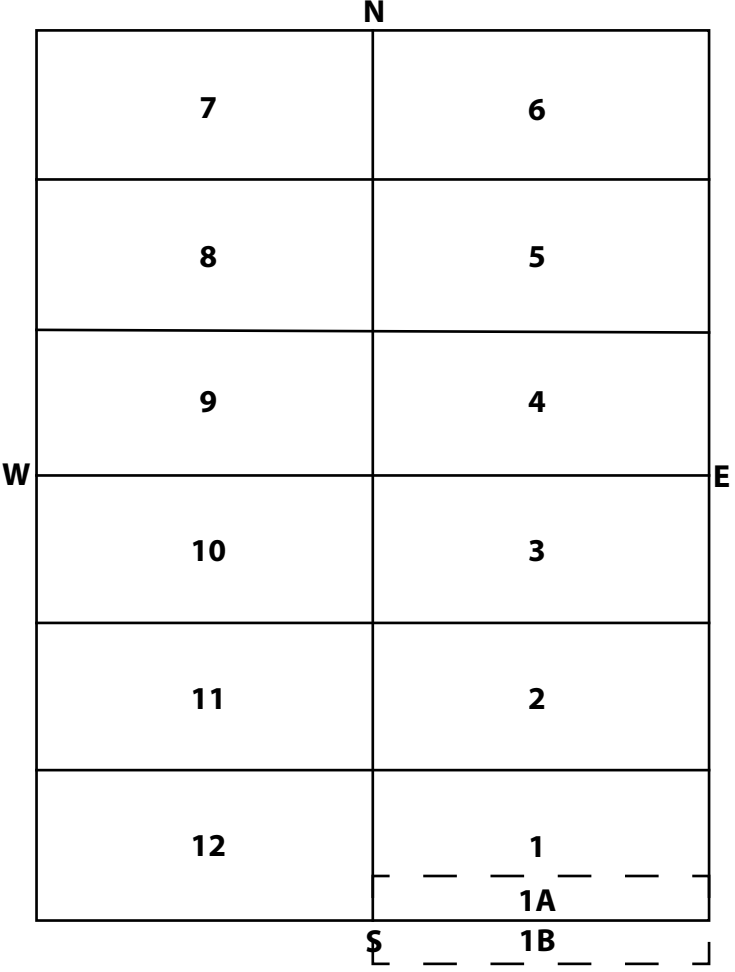

**OWNER #1:** Moore, E.G.  
**#1B:** Brown, Mrs. Frank (4 Dec 1962)  
**#2-3:** Brown, Lon B. (26 May 1951) from Moore, E.G.  
**#4-12:** Moore, E.G.

# Highland Cemetery

SEC. 1 BLK. 118 LOT \_\_\_\_\_ SIZE \_\_\_\_\_

INTERMENTS		
NO.	NAME	DATE
1	<i>Dodds, Joseph E. (b. ????)</i>	<i>???? 11 Dec 1942</i>
2	<i>Dodds, Cora Belle (b. 1873)</i>	<i>21 Oct 1913 23 Oct 1913</i>
3	<i>Ramsey, Beulah M. Bowers (b. 1886)</i>	<i>5 Mar 1981 30 May 1981</i>
4		
5	<i>Pender, Albert Orson (b. ????)</i>	<i>???? 25 Oct 1930</i>
6	<i>Peavey, Infant daughter of G.A. (b. ????)</i>	<i>1 May 1887 1 May 1887</i>
7		
8		
9		
10	<i>Dodds, Mary Francis (b. 22 Aug 1846)</i>	<i>2 May 1922 4 May 1922</i>
11	<i>Dodds, Richard B. (b. 17 Sep 1840)</i>	<i>1 Jan 1914 3 Jan 1914</i>
12	<i>Sharp, Minnie A. (b. 1885)</i>	<i>1918 4 May 1918</i>

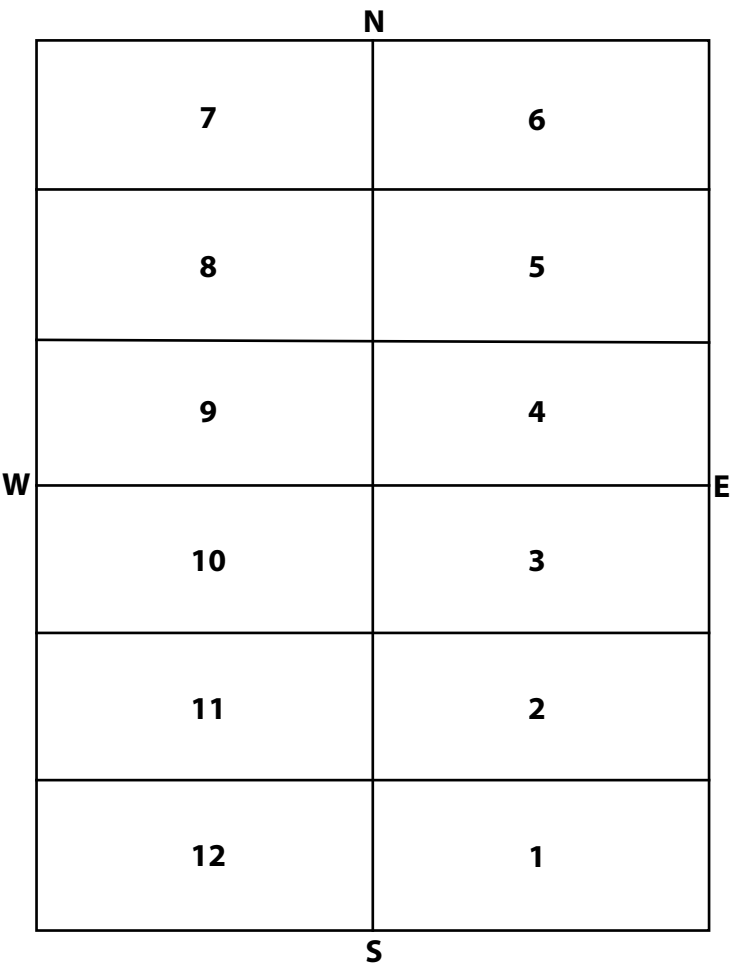

OWNER #1-3, 10-12: Dodds, Joseph E. S 1/2  
#4-9: Peavey, G.A. N 1/2  
 \_\_\_\_\_  
 \_\_\_\_\_  
 \_\_\_\_\_

# Highland Cemetery

SEC.   1   BLK.   119   LOT \_\_\_\_\_ SIZE \_\_\_\_\_

INTERMENTS		
NO.	NAME	DATE
1		
2		
3		
4		
5		
6		
7		
8	Corn, Ephraim R. (b. 1860)	14 Mar 1915 17 Mar 1915
9		
10		
11		
12		
	Kalenberger, Mr. (buried man) (b. ????)	4 Apr 1887 1887
	Kalenberger, Infant Son (b. ????)	21 Feb 1887 1887
	Cramer, Mr. (b. ????)	28 Mar 1887 1887

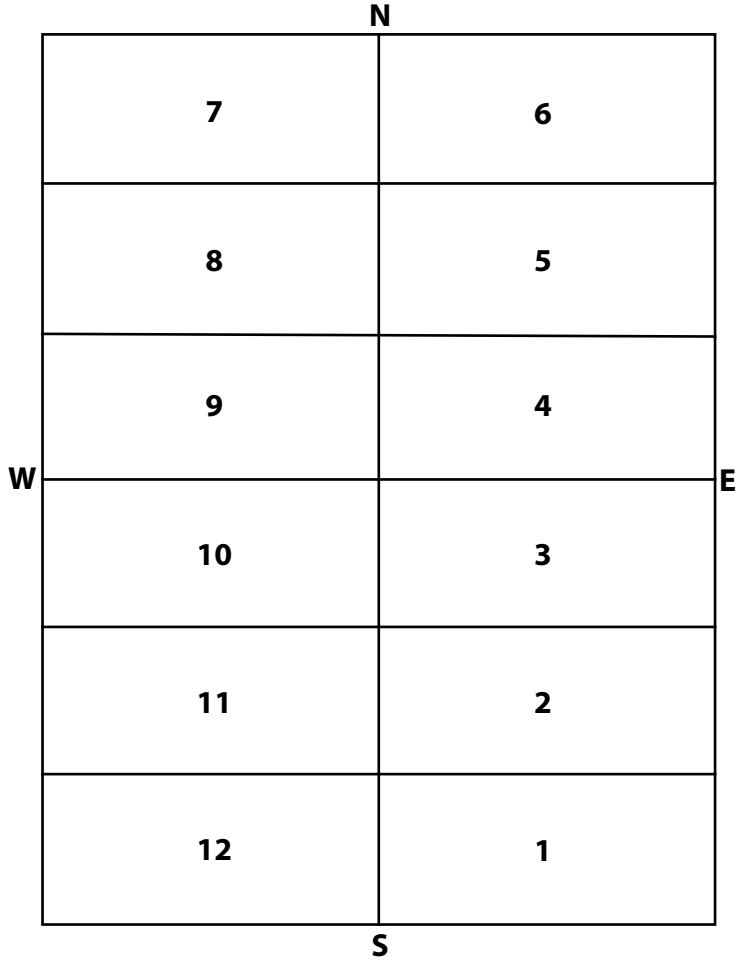

**OWNER** #1-3, 10-12: Kalenberger, G.B. S 1/2 Book B, p. 34

#4-9: Creamer, Mary N 1/2 (29 Mar 1887) Book B, p. 34

#8: Corn, Ephraim R. removed to Sec. 3, Lot 282 (9 Jun 1917)

# Highland Cemetery

SEC.   1   BLK.   120   LOT            SIZE           

<b>INTERMENTS</b>		
NO.	NAME	DATE
1	Clark, Infant of P. (b. ????)	???? 18 Apr 1896
2		
3		
4		
5		
6		
7		
8		
9		
10		
11		
12	Clark, Wallace W. (b. ????)	27 Mar 1896 28 Mar 1896

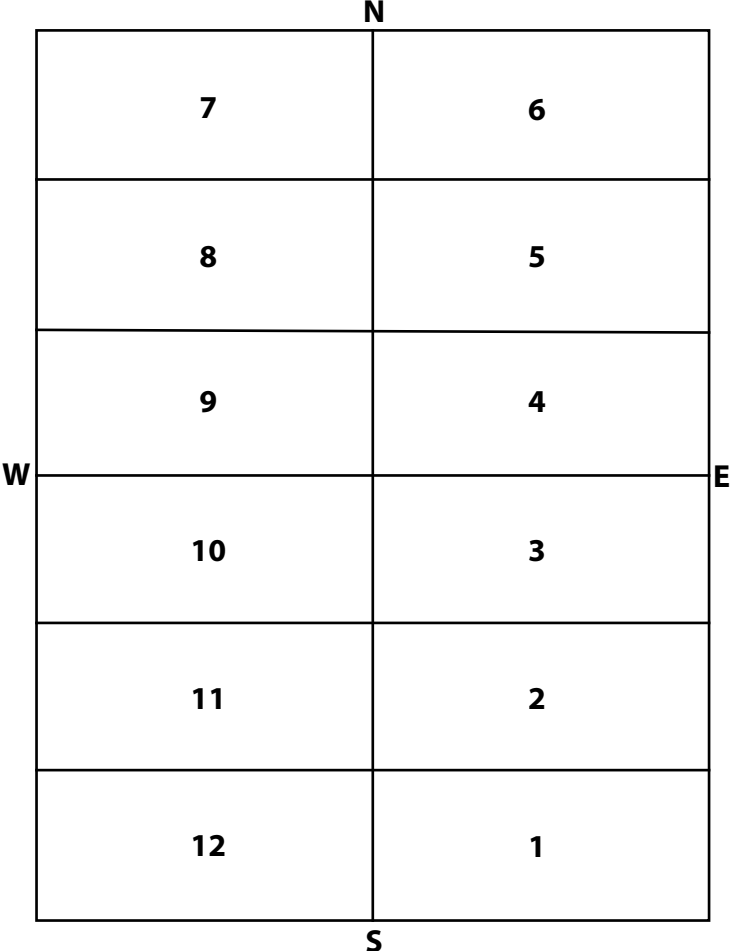

**OWNER** #1-3, 10-12: Clark, W.W. S 1/2 (16 Jan 1887)  
 #4-9: Draper, B.F. N 1/2 (16 Jan 1887) Book B, p. 33

---



---



---

# Highland Cemetery

SEC. 1 BLK. 121 LOT \_\_\_\_\_ SIZE \_\_\_\_\_

## INTERMENTS

NO.	NAME	DATE
1	Fitzgerald, C.A. (b. ????)	???? 17 Jul 1893
2		
3	Fitzgerald, Denna (b. ????)	???? 17 Jul 1898
4	Nichols, Fannie May (b. 13 May 1854)	28 May 1901 30 May 1901
5		
6		
7	Taylor, Sarah (b. 14 Aug 1842)	29 May 1916 31 May 1916
8	Taylor, Harry R. (b. 27 Aug 1867)	14 Aug 1886 16 Aug 1886
9	Taylor, William H. (b. 20 Mar 1836)	22 Feb 1906 24 Feb 1906
10		
11		
12	Wright, John W. (b. ????)	24 Dec 1911 26 Dec 1911

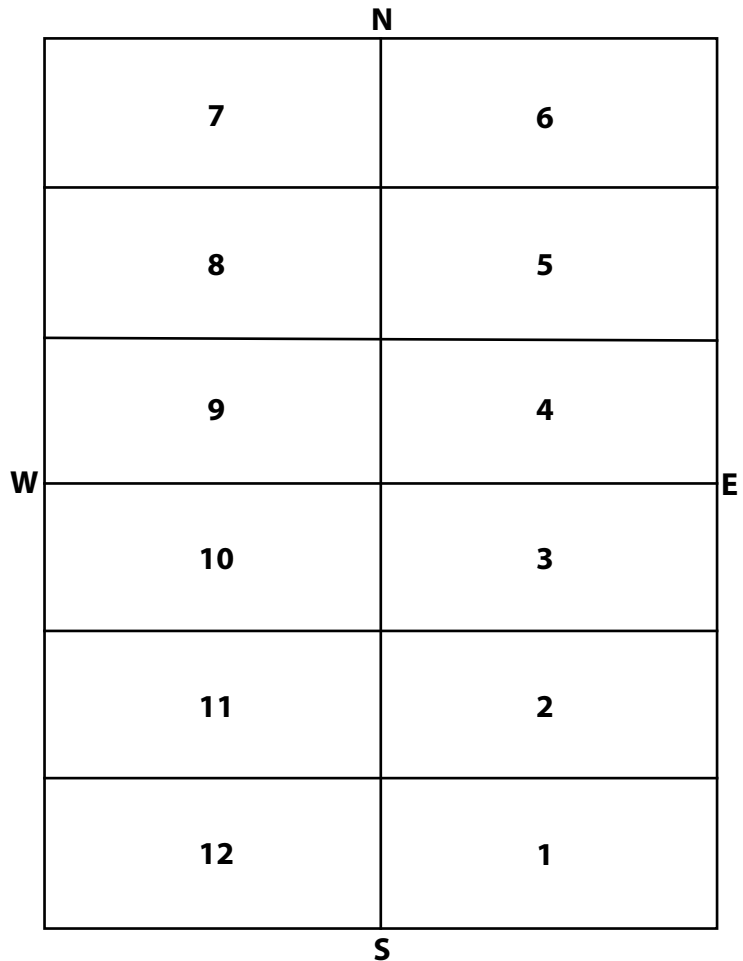

OWNER #1-3, 10-12: Fitzgerald, C.A. S 1/2

#4-9: Taylor, Sarah N 1/2

\_\_\_\_\_  
\_\_\_\_\_  
\_\_\_\_\_

# Highland Cemetery

SEC. 1 BLK. 122 LOT \_\_\_\_\_ SIZE \_\_\_\_\_

## INTERMENTS

NO.	NAME	DATE
1	Beitzel, Charles F. (b. Oct 1843)	26 Jan 1906 27 Jan 1906
2	Beitzel, Catharine H. (b. Nov 1844)	15 Dec 1914 16 Dec 1914
3	Beitzel, Charles J. (b. Apr 1872)	14 May 1931 15 May 1931
4		
5		
6		
7		
8		
9	Haden, Samuel L. (b. 1884)	2 Oct 1916 4 Oct 1916
10		
11	Erick, Elizabeth M. (b. 1858)	1928 4 Feb 1928
12	Erick, Julius C. (b. 1854)	1924 25 Jul 1924

		N	
	7		6
	8		5
	9		4
W	10		3
	11		2
	12		1
		S	
			E

**OWNER** #1-3: Beitzel, Elizabeth ? SE 1/4  
#4-9: Minnick, W.A. to Haden, Mrs. S.L. - for sale by Mrs. Dicie E. Haden (30 Jun 1964)  
#10-12: Erick, Elizabeth SW 1/4  
#9 Haden, Samuel removed (18 Dec 1920) to Maple Grove Cemetery

# Highland Cemetery

SEC. 1 BLK. 123 LOT \_\_\_\_\_ SIZE \_\_\_\_\_

INTERMENTS		
NO.	NAME	DATE
1		
2		
3		
4		
5		
6		
7	<i>Davis, Charlie H. (b. 1882)</i>	<i>13 Sep 1896</i> <i>13 Sep 1896</i>
8	<i>Davis, James (b. 1821)</i>	<i>14 Jul 1886</i> <i>15 Jul 1886</i>
9	<i>Davis, Elizabeth (b. 25 Dec 1830)</i>	<i>28 Dec 1906</i> <i>31 Dec 1906</i>
10		
11		
12	<i>Hoffman, Lyona M. (b. 21 Mar 1887)</i>	<i>24 Mar 1887</i> <i>24 Mar 1887</i>
12A	<i>Hoffman, Harriet A. (b. 21 Sep 1884)</i>	<i>10 Aug 1886</i> <i>11 Aug 1886</i>

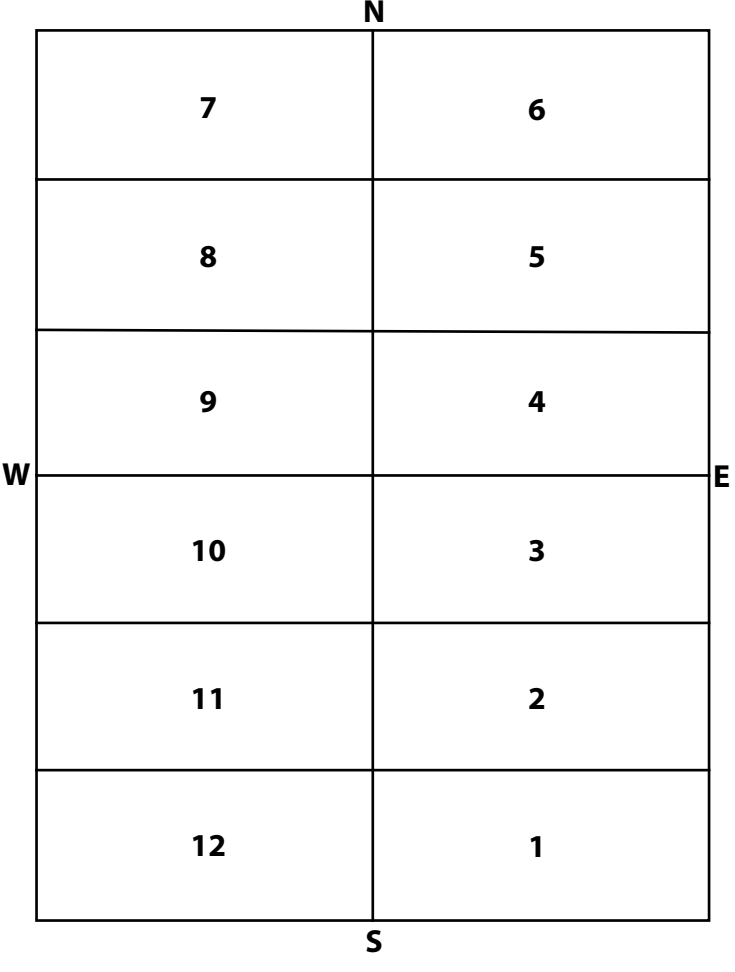

**OWNER** #1-3, 10-12: Hoffman, E.L. S 1/2  
 #4-9: Davis, Elizabeth N 1/2



# Highland Cemetery

SEC. 1 BLK. 124 LOT \_\_\_\_\_ SIZE \_\_\_\_\_

INTERMENTS		
NO.	NAME	DATE
1		
2		
3	<i>Tibbets, Nellie (b. ????)</i>	<i>???? 9 Apr 1886</i>
4		
5		
6		
7		
8	<i>Marlatt, Annie (b. 1856)</i>	<i>2 Feb 1886 4 Feb 1886</i>
9		
10		
11		
12		

	7A	N	6A
	7		6
	8		5
	9		4
W	10		3
	11		2
	12		1
		S	

OWNER #1-3, 10-12: Tibbets, C.E. S 1/2  
 #4-9: Marlatt, J. N 1/2 (3 Feb 1886)  
 \_\_\_\_\_  
 \_\_\_\_\_

# Highland Cemetery

SEC. 1 BLK. 125 LOT \_\_\_\_\_ SIZE \_\_\_\_\_

INTERMENTS		
NO.	NAME	DATE
1	<i>Reischmann, Truman H. (b. 6 Oct 1884)</i>	<i>2 Jan 1912 4 Jan 1912</i>
2	<i>Fuller, Salena (b. 22 Dec 1826)</i>	<i>16 Nov 1906 16 Nov 1906</i>
3	<i>Lindenberger, Lena Stevens (b. 13 Sep 1886)</i>	<i>26 Jul 1969 29 Jul 1969</i>
4		
5		
6		
5		
6		
7		
8		
9		
10	<i>Stevens, Nellie J. (b. 3 Sep 1885)</i>	<i>21 Apr 1886 21 Apr 1886</i>
11	<i>Stevens, Fannie E. (b. 1 Nov 1889)</i>	<i>29 Jun 1895 29 Jun 1895</i>
12	<i>Stevens, Ed G.P. (b. 1882)</i>	<i>5 Nov 1896 5 Nov 1896</i>
12A	<i>Lindenberger, Thomas Dean (b. 1 Jun 1926)</i>	<i>23 Aug 1971 26 Aug 1971</i>

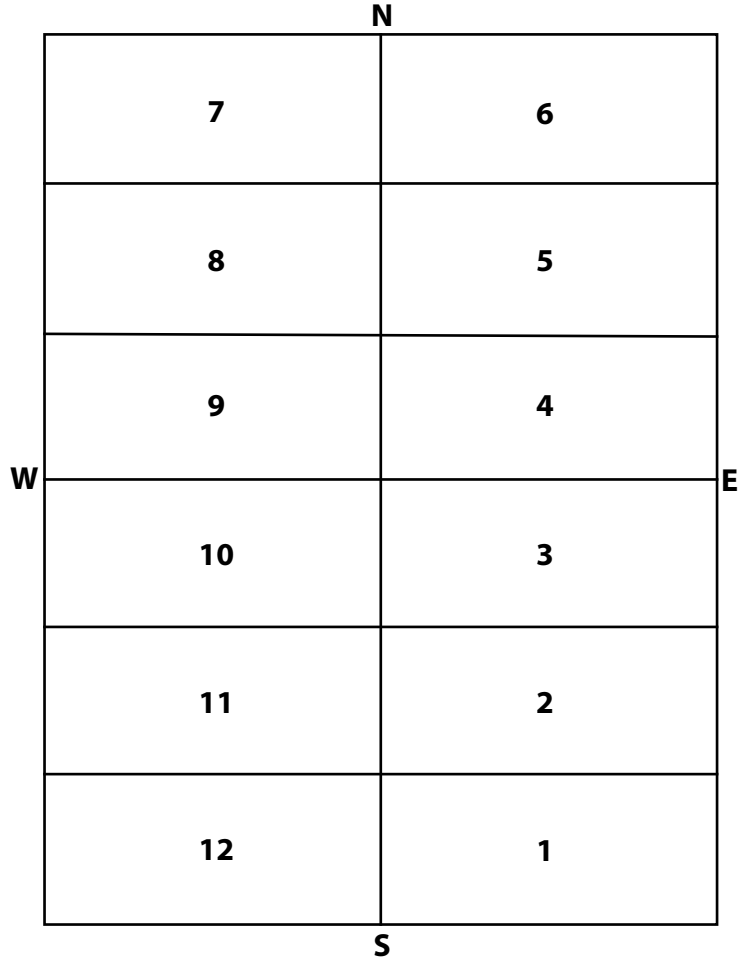

**OWNER** #1-3, 10-12: Stevens, Phillip G. S 1/2  
 #4-9: Driscoll, T.E. N 1/2  
 #12A: Mosier, Sandra Kay - 1326 Dellrose

# Highland Cemetery

SEC. 1 BLK. 126 LOT \_\_\_\_\_ SIZE \_\_\_\_\_

INTERMENTS		
NO.	NAME	DATE
1	<i>Stevens, Gladys (b. 17 Nov 1894)</i>	<i>26 May 1919 28 May 1919</i>
1A	<i>Mote, Martin Aaron (b. 19 May 1914)</i>	<i>18 Jul 1957 20 Jul 1957</i>
2	<i>Lynch, Anna Cordelia (b. 19 Jan 1862)</i>	<i>2 Mar 1926 5 Mar 1926</i>
3	<i>Mote, Martin (b. ?????)</i>	<i>11 Oct 1917 13 Oct 1917</i>
4	<i>Tuders, Elmira E. (b. 21 Oct 1850)</i>	<i>11 Sep 1930 15 Sep 1930</i>
5		
6		
7		
8		
9		
10	<i>Mote, Aaron (b. ?????)</i>	<i>13 Nov 1876 ????</i>
11		
12		

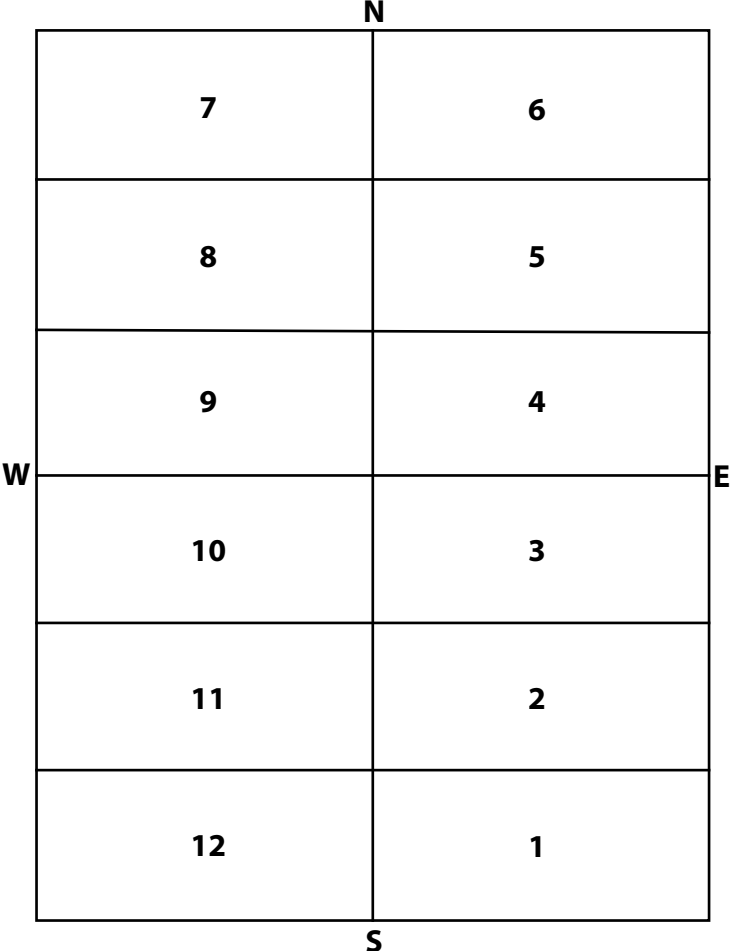

OWNER #1-4: Single graves  
 #5-6: Lockwood, B.  
 #7-12: G.A.R. W1/2

# Highland Cemetery

SEC. 1 BLK. 127 LOT \_\_\_\_\_ SIZE \_\_\_\_\_

INTERMENTS		
NO.	NAME	DATE
1		
2	Nichols, Henry (b. 1838)	8 Jan 1886 11 Jan 1886
3		
4	May be filled - Russell	
5	May be filled - Russell	
6	May be filled - Russell	
7	Green, Infant of W.A. (b. ?????)	???? 18 Dec 1885
8	Mixon, Mrs. Fannie (b. ?????)	25 Sep 1890 1890
9	Green, A.B. (b. 6 May 1833)	4 Jun 1901 6 Jun 1901
10		
11	Reed, Lydia (b. ?????)	1885 1885
12	Reed, Nealy (b. 1881)	1884 1884

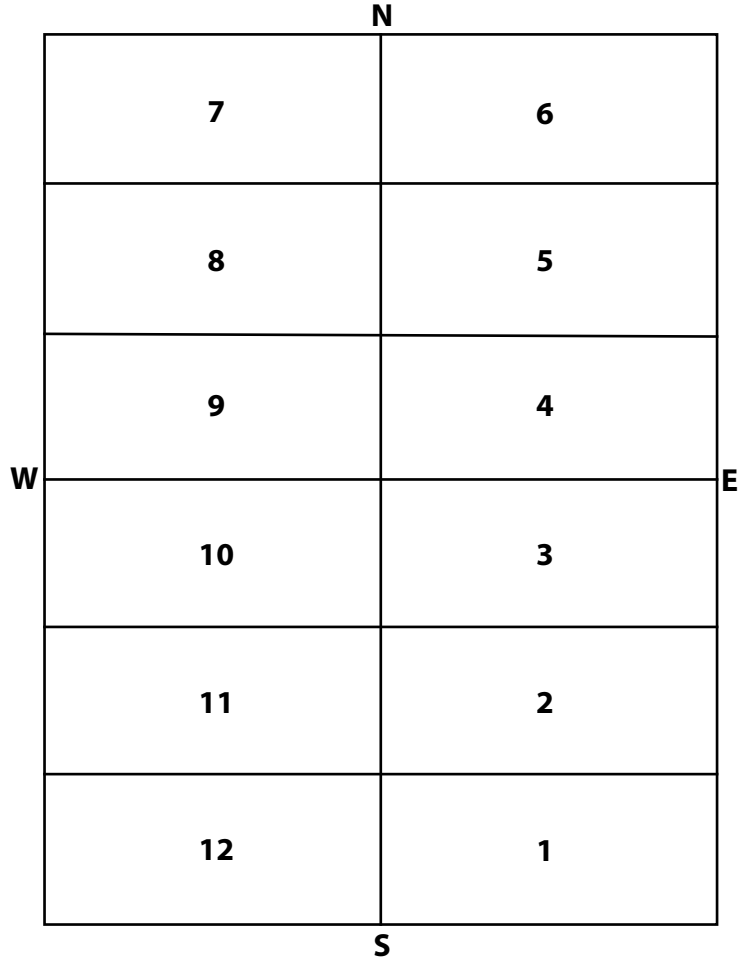

**OWNER #1-3: Nichols, Mrs. Henry SE 1/4**  
**#4-6: Russell, Frank NE 1/4 (23 Dec 1885) Book B, p. 30 - graves were dug.**  
**#7-9: Green, W.A. NW 1/4**  
**#10-12: Reed, Charles M. SW 1/4**

# Highland Cemetery

SEC. 1 BLK. 128 LOT \_\_\_\_\_ SIZE \_\_\_\_\_

INTERMENTS		
NO.	NAME	DATE
1		
2		
3		
4		
5		
6		
7		
8		
9		
10		
11		
12		
	Samyer, Alonzo W. (b. ?????)	23 Apr 1886 24 Apr 1886

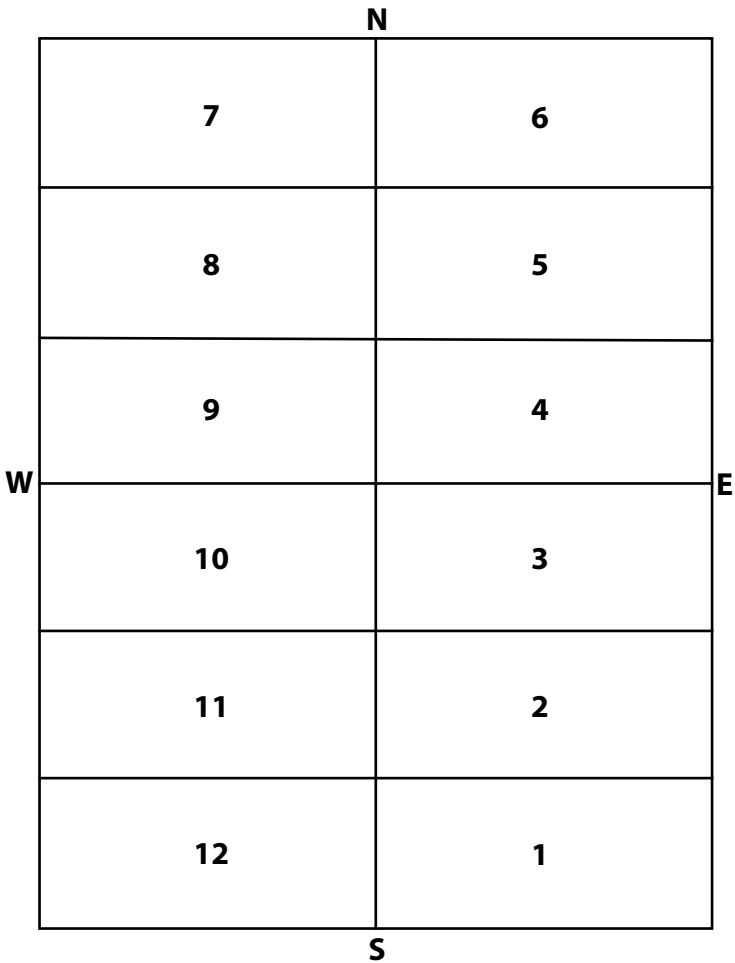

**OWNER** #1-3, 10-12: Haines, John S 1/2 (28 Apr 1886) Book B, p. 31  
#4-6: Dester, H.A. NE 1/4 (10 Jun 1886) Book B, p. 31  
#7-9: Lane, James NW 1/4 (24 Apr 1886) Book B, p. 31

# Highland Cemetery

SEC. 1 BLK. 129 LOT \_\_\_\_\_ SIZE \_\_\_\_\_

INTERMENTS		
NO.	NAME	DATE
1		
2	Nordyke, Rhoda A. (b. ????)	13 Jan 1898 15 Jan 1898
3		
4	Nordyke, Dora A. (b. 1886)	14 Aug 1886 14 Aug 1886
5	Reeves, William Eugene (b. 1856)	27 Feb 1916 29 Feb 1916
6		
7		
8		
9	Stockinger, Mary E. (b. 1853)	22 Jun 1886 22 Jun 1886
10		
11		
12		

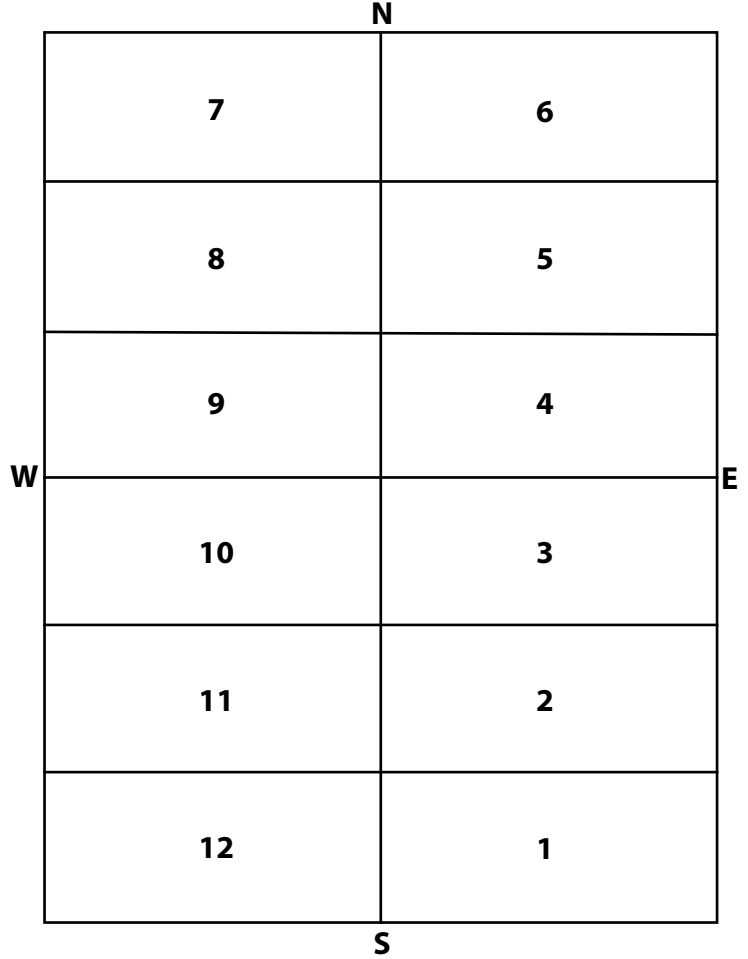

OWNER #1-3: Nordyke, Alonzo SE 1/4  
#4-6: Reeves, W.E. NE 1/4  
#7-9: Stockinger, G.A. NW 1/4  
#10-12: Burch, N.A. SW 1/4 (26 Jul 1886) Book B, p. 32



# Highland Cemetery

SEC. 1 BLK. 131 LOT \_\_\_\_\_ SIZE \_\_\_\_\_

### INTERMENTS

NO.	NAME	DATE
1	Miller, John William (b. 29 Feb 1852)	18 Oct 1886 18 Oct 1886
2	Harrison, Ollie Jeanette (b. 12 Aug 1857)	9 Apr 1927 11 Apr 1927
3	Harrison, John C. (b. 1858)	1938 29 Sep 1938
4		
5A	Fennell, Infant Son (b. ????)	???? ????
5B	Fennell, James (b. ????)	19 Nov 1891 20 Nov 1891
6A	Fennell, Anna (b. ????)	???? ????
6B	Fennell, Lilly (b. ????)	???? ????
7		
8	Anderson, Henry (b. 1822)	1895 16 Oct 1895
9	Anderson, Mary (b. ????)	???? 16 Oct 1895
10		
11		
12		

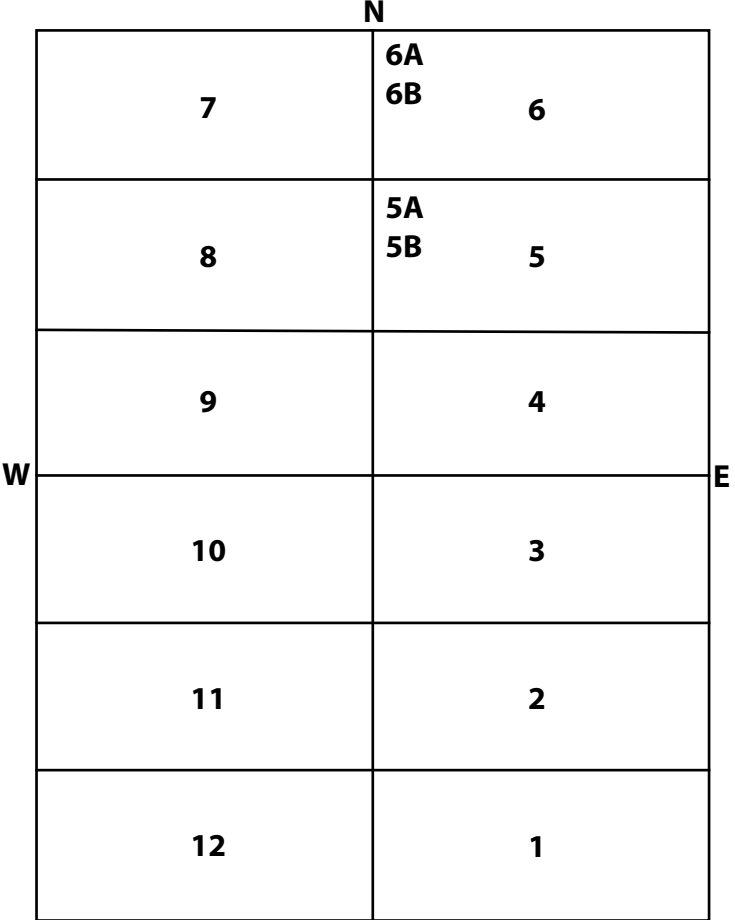

- OWNER #1-3:** Miller, Ollie SE 1/4
- 
- #4-6B:** Fennell, Ed NE 1/4
- 
- #7-9:** Kennedy, G. NW 1/4
- 
- #10-12:** Crooks, Amanda SW 1/4
- 
- #9:** Mary Anderson removed (16 Oct 1895)



# Highland Cemetery

SEC. 1 BLK. 132 LOT \_\_\_\_\_ SIZE \_\_\_\_\_

INTERMENTS		
NO.	NAME	DATE
1		
2	<i>Conway, Nancy (b. 10 Dec 1831)</i>	<i>4 Dec 1889 4 Dec 1889</i>
3	<i>Conway, John (b. 1 Jan 1821)</i>	<i>12 Jul 1900 13 Jul 1900</i>
4		
5		
6		
7		
8		
9		
10		
11		
12		
	<i>Wendel, Margretha (b. 20 Sep 1846)</i>	<i>18 Aug 1886 20 Aug 1886</i>

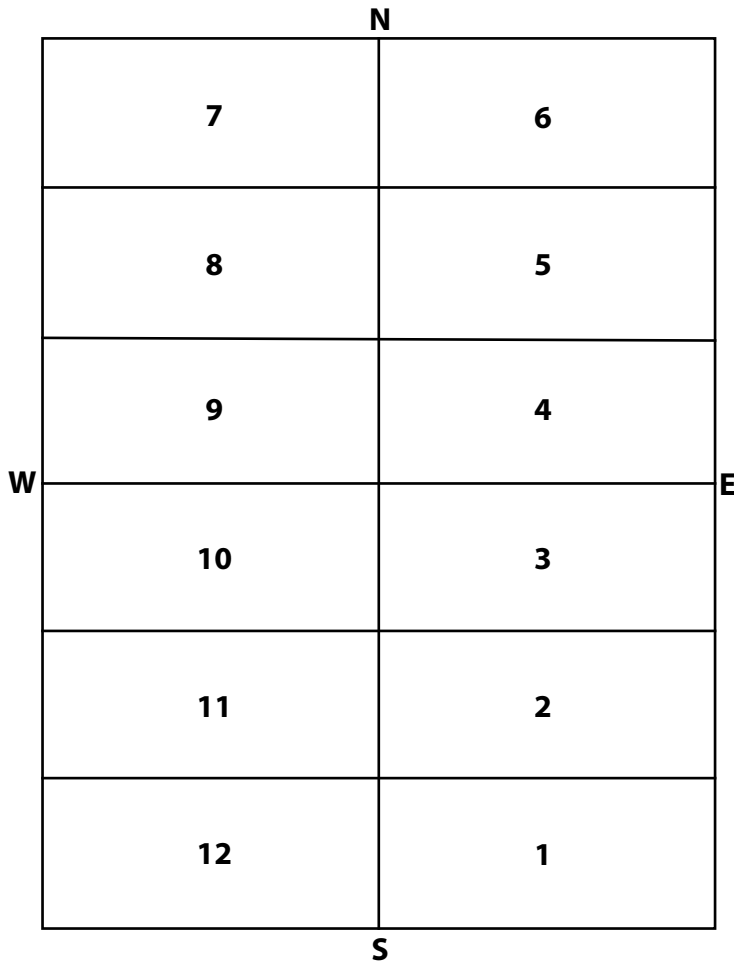

**OWNER** #1-3: Conway, John W. SE 1/4  
#4-9: Wendel, Dr. A.H. N 1/2 (20 Oct 1886) Book B, p. 32  
#10-12: Primrose, I.P. SW 1/4 (20 Oct 1886) Book B, p. 32

# Highland Cemetery

SEC. 1 BLK. 133 LOT \_\_\_\_\_ SIZE \_\_\_\_\_

## INTERMENTS

NO.	NAME	DATE
1	Powell, Claudie (b. ????)	9 Feb 1888 9 Feb 1888
2	Smith, Etta (b. 20 Jul 1860)	29 Mar 1904 31 Mar 1904
3	Weeks, Roy W. (b. 1886)	25 Jan 1887 25 Jan 1887
4	Tester, Levica (b. 1858)	1917 6 Oct 1917
5		
6		
6A	Tester, Lewis W. (b. 1852)	1936 5 Mar 1936
7		
8	Swann, George F. (b. 1879)	20 Jan 1887 20 Jan 1887
9		
10		
11		
12		

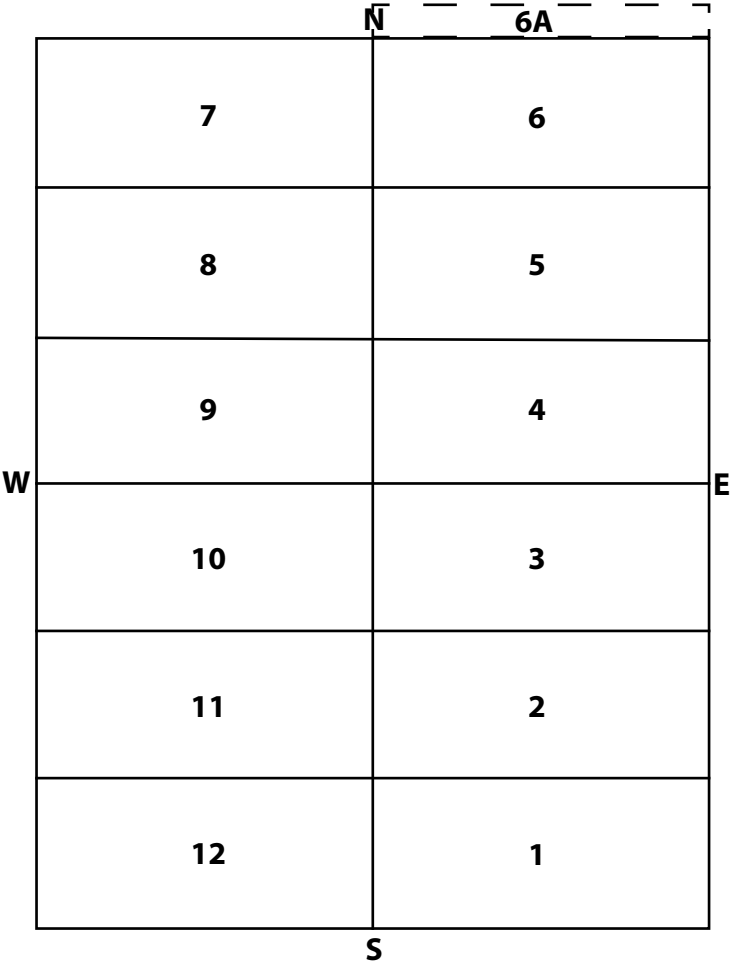

**OWNER #1-3:** Weeks, A.R. SE 1/4

---

**#4-6:** Williams, J.G. NE 1/4

---

**#7-9:** Nash, W.J. NW 1/4

---

**#10-12:** Hoff, Charles SW 1/4 see also Sec 2, Block 68

---

**#4:** Williams, Effie May removed (7 May 1915)

# Highland Cemetery

SEC. 1 BLK. 134 LOT \_\_\_\_\_ SIZE \_\_\_\_\_

INTERMENTS		
NO.	NAME	DATE
1		
2		
3		
4		
5		
6		
7	<i>Allen, Infant (b. 8 May 1908)</i>	<i>8 May 1908 9 May 1908</i>
8		
9	<i>Sumption, Jennie E. (b. ????)</i>	<i>???? 21 Mar 1925</i>
10		
11		
12		

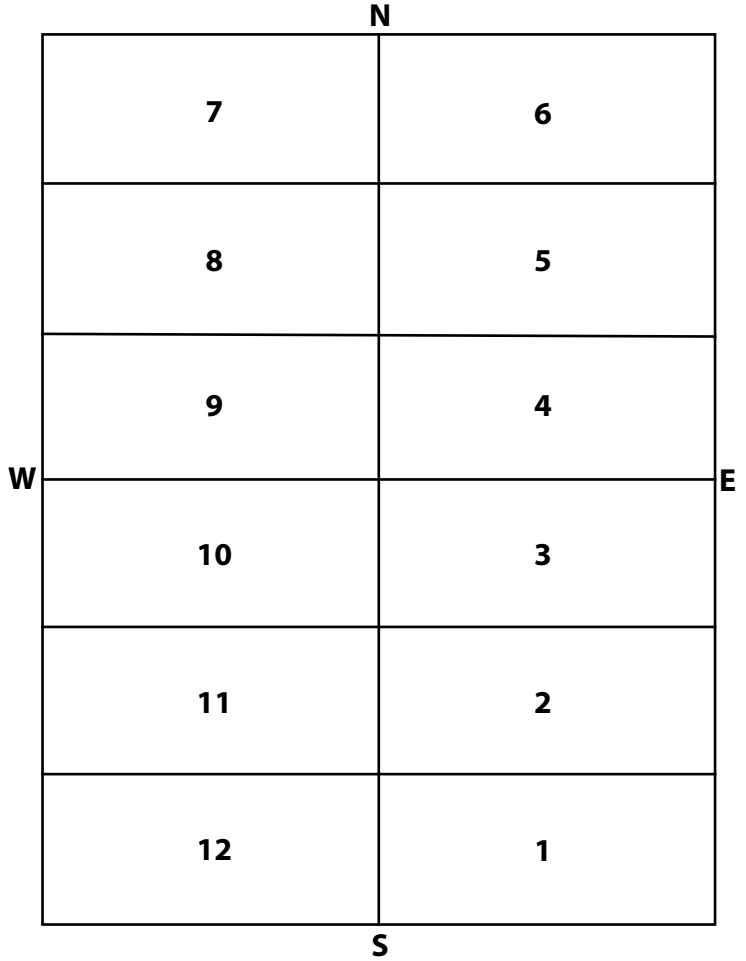

**OWNER** #1-3, 10-12: Cobb S 1/2 (2 Dec 1886) Book B, p. 33  
#4-9: Sumption, Bion B. N 1/2

---



---



---

# Highland Cemetery

SEC. 1 BLK. 135 LOT \_\_\_\_\_ SIZE \_\_\_\_\_

## INTERMENTS

NO.	NAME	DATE
1	Carpenter, Allen Roy (b. ????)	???? 24 Jul 1916
2		
3	Hummelke, Lydia Anna (b. 30 Jan 1875)	7 Jun 1960 10 Jun 1960
4		
5		
6		
7		
8		
9		
10	Hummelke, Fred (b. ????)	???? 5 Jul 1952
11	Hummelke, Margreth (b. ????)	???? 13 Dec 1926
12	Hummelke, Charles (b. 28 Nov 1839)	8 Mar 1883 8 Mar 1883

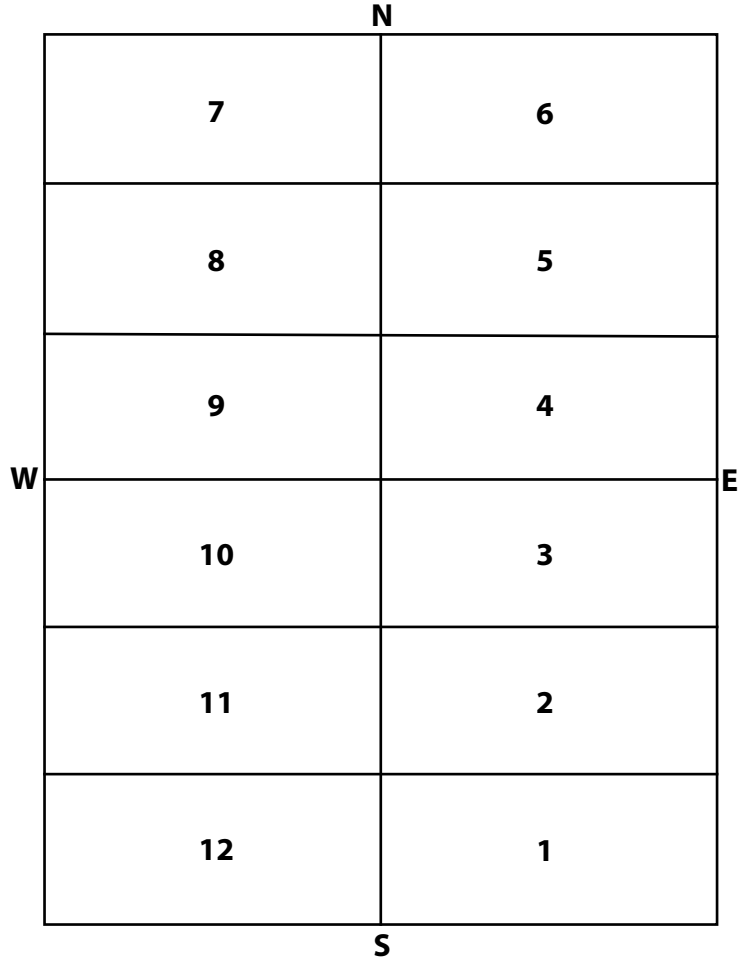

**OWNER** #1-3, 10-12: Hummelke, Mereth S 1/2  
 #4-9: Benton, Orien N 1/2 (4 Dec 1886) Book B, p. 33

# Highland Cemetery

SEC.   1   BLK.  136  LOT        SIZE       

INTERMENTS		
NO.	NAME	DATE
1		
2		
3		
4	<i>Wought, Henry (b. ????)</i>	<i>6 Jan 1912 8 Jan 1912</i>
5		
6		
7		
8	<i>Woltz, Frances A. (b. 30 Oct 1853)</i>	<i>12 Jul 1907 15 Jul 1907</i>
9	<i>Woltz, Charles William (b. 19 Sep 1844)</i>	<i>16 Nov 1918 19 Nov 1918</i>
10	<i>Hembrow, Henerita (b. 1875)</i>	<i>23 Dec 1886 23 Dec 1886</i>
11	<i>Hembrow, Mattie (b. 1885)</i>	<i>10 Nov 1887 10 Nov 1887</i>
12		

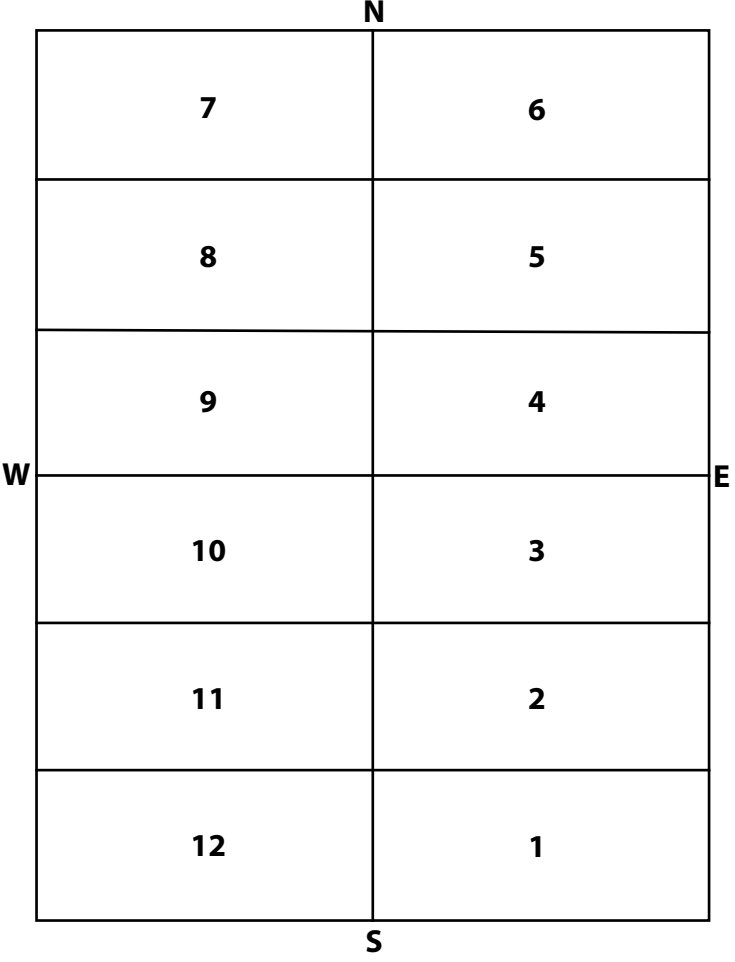

**OWNER** *#1-3, 10-12: Hembrow, Charles S 1/2*

*#4-9: Woltz, C.W. N 1/2*

# Highland Cemetery

SEC. 1 BLK. 137 LOT \_\_\_\_\_ SIZE \_\_\_\_\_

INTERMENTS		
NO.	NAME	DATE
1	<i>McKee, Schuyler A. (b. 17 Mar 1883)</i>	<i>25 Mar 1883 25 Mar 1883</i>
2	<i>McKee, Owen G. (b. 14 Jun 1884)</i>	<i>15 Feb 1887 15 Feb 1887</i>
3		
4	<i>McKee, Robert Lorenzo (b. 3 Mar 1919)</i>	<i>17 Jul 1920 19 Jul 1920</i>
4A	<i>Hendrix, Wesley E. (b. 11 May 1943)</i>	<i>11 May 1943 12 May 1943</i>
5	<i>McKee, Silvia (b. 22 Feb 1896)</i>	<i>26 Nov 1902 30 Nov 1902</i>
6		
7	<i>McKee, William G. (b. 1852)</i>	<i>1924 18 Oct 1924</i>
8	<i>McKee, Margaret A. (b. 1853)</i>	<i>14 Apr 1931 21 Apr 1931</i>
9		
10		
11		
12		
	<i>Beaman, Mrs. (b. ?????)</i>	<i>2 Mar 1887 1887</i>

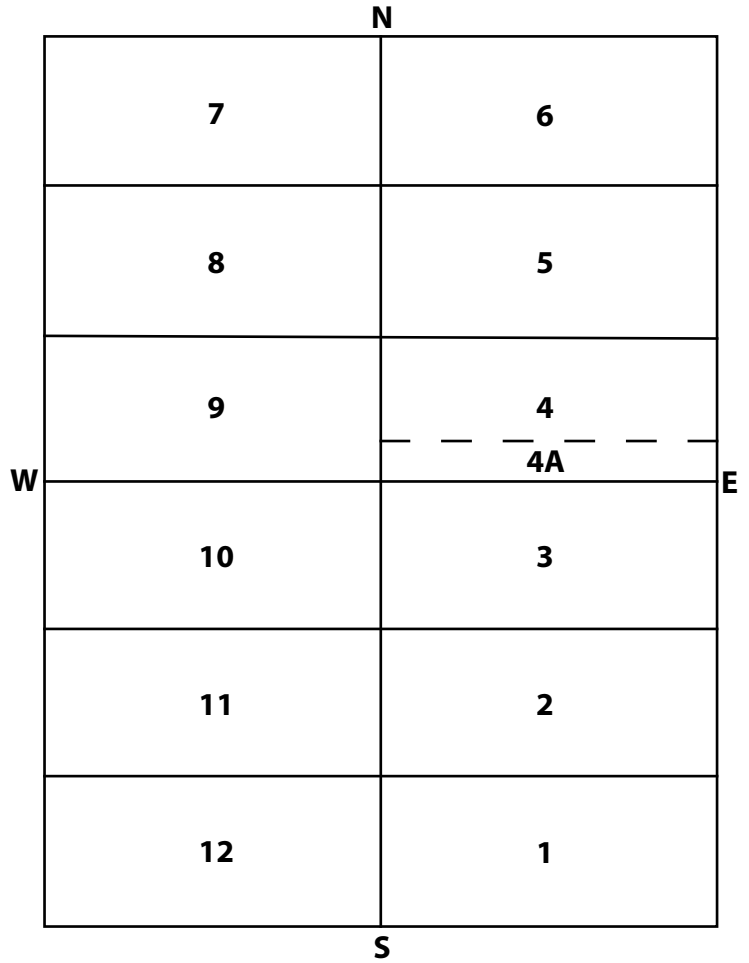

**OWNER** #1-3, 10-12: Beaman, John E. S 1/2 (2 Mar 1887) Book B,  
p. 34  
 #4-9: McKee, W.G. N 1/2



# Highland Cemetery

SEC. 1 BLK. 139 LOT \_\_\_\_\_ SIZE \_\_\_\_\_

INTERMENTS		
NO.	NAME	DATE
1	<i>Ebenhack, Will (b. 8 Mar 1863)</i>	<i>9 Nov 1902 11 Nov 1902</i>
2	<i>Conly, Willie "Francis" (b. Jul 1894)</i>	<i>2 Feb 1906 3 Feb 1906</i>
3	<i>Conly, Marguerite (b. Apr 1870)</i>	<i>4 Jun 1916 6 Jun 1916</i>
4	<i>Ebenhack, Mrs. Mary (b. ????)</i>	<i>16 Jun 1896 18 Jun 1896</i>
5	<i>Ebenhack, Henry (b. ????)</i>	<i>???? ????</i>
6	<i>Evans, Cynthia A. (b. 21 Dec 1858)</i>	<i>8 Feb 1941 11 Feb 1941</i>
7	<i>Ebenhack, Mary (b. Feb 1860)</i>	<i>???? 14 Jul 1946</i>
8	<i>Hoenscheidt, John (b. Apr 1849)</i>	<i>8 Apr 1931 11 Apr 1931</i>
9	<i>Conly, John (b. Oct 1896)</i>	<i>2 Sep 1925 5 Sep 1925</i>
10	<i>Hoenscheidt, William H. (b. 28 Sep 1880)</i>	<i>2 Nov 1921 4 Nov 1921</i>
11	<i>Hoenscheidt, Herman (b. 12 Sep 1845)</i>	<i>9 Sep 1905 10 Sep 1905</i>
12	<i>Hoenscheidt, Frank M. (b. 4 Dec 1885)</i>	<i>2 Feb 1887 31 Jan 1887</i>

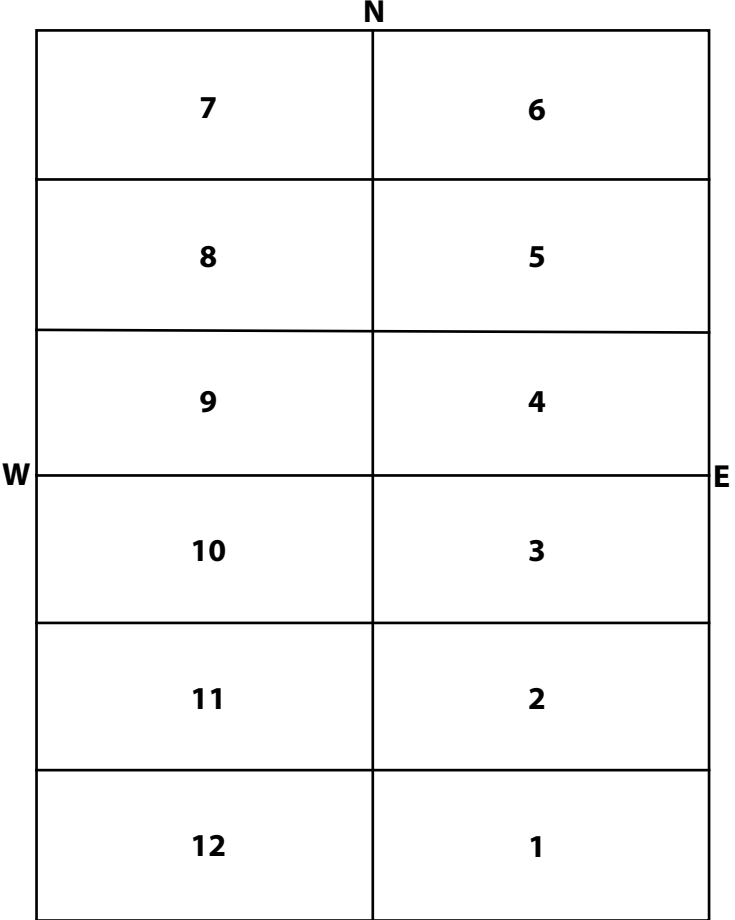

OWNER Hoenscheidt, John

\_\_\_\_\_

\_\_\_\_\_

\_\_\_\_\_



# Highland Cemetery

SEC. 1 BLK. 140 LOT \_\_\_\_\_ SIZE \_\_\_\_\_

## INTERMENTS

NO.	NAME	DATE
1		
2		
3		
4		
5		
6		
7	<i>Wickham, Martha (b. 1834)</i>	<i>13 Aug 1887</i> <i>13 Aug 1887</i>
8		
9		
10		
11		
12		
	<i>Davis, Infant Son (b. ????)</i>	<i>3 Jan 1887</i> <i>1887</i>

		N	
	7		6
	8		5
	9		4
W			
	10		3
	11		2
	12		1
		S	
			E

OWNER #1-3, 10-12: *Davis, F.T. S 1/2 (3 Jan 1887) Book B, p. 33*  
 #4-9: *Wickham, John N 1/2 (14 Aug 1887)*

---



---

# Highland Cemetery

SEC. 1 BLK. 141 LOT \_\_\_\_\_ SIZE \_\_\_\_\_

## INTERMENTS

NO.	NAME	DATE
1		
2		
3	Crane, Noah (b. ????)	31 Jul 1899 2 Aug 1899
4		
5		
6		
7		
8		
9		
10	Ritchie, John S. (b. 1849)	1934 23 Apr 1934
11	Ritchie, Alice L. (b. 1857)	12 Aug 1887 1887
12		

N	
7	6
8	5
9	4
10	3
11	2
12	1
S	

**OWNER** #1-3, 10-12: Ritchie, J.S. S 1/2  
 #4-9: Herring, Constantine N 1/2 (14 Apr 1886) Book B, p. 31

# Highland Cemetery

SEC. 1 BLK. 142 LOT \_\_\_\_\_ SIZE \_\_\_\_\_

INTERMENTS		
NO.	NAME	DATE
1	<i>Reynolds, Fred F. (b. 6 Apr 1879)</i>	<i>24 Sep 1946 26 Sep 1946</i>
2		
3		
4		
5		
6	<i>Ferris, Bessie S. (b. 1870)</i>	<i>12 Oct 1874 12 Oct 1874</i>
7		
8		
9		
10		
11		
12		

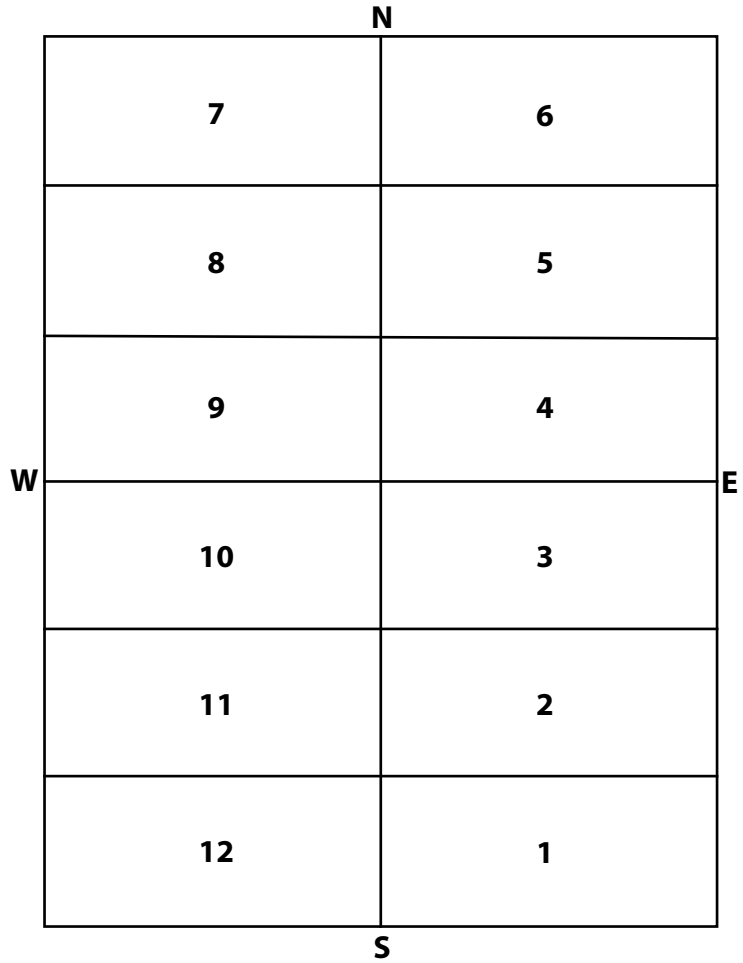

OWNER Ferris, William R.  
\_\_\_\_\_  
\_\_\_\_\_  
\_\_\_\_\_

# Highland Cemetery

SEC.   1   BLK.   143   LOT \_\_\_\_\_ SIZE \_\_\_\_\_

**INTERMENTS**

NO.	NAME	DATE
1		
2		
3		
4		
5		
6	<i>Weaver, Anna M. (b. 9 May ????)</i>	<i>26 Sep 1906 28 Sep 1906</i>
7		
8	<i>Stevens, Herbert U. (b. ????)</i>	<i>1 May 1894 1894</i>
9	<i>Philleo, Edward C. (b. ????)</i>	<i>5 Nov 1886 1886</i>
10		
11		
12		

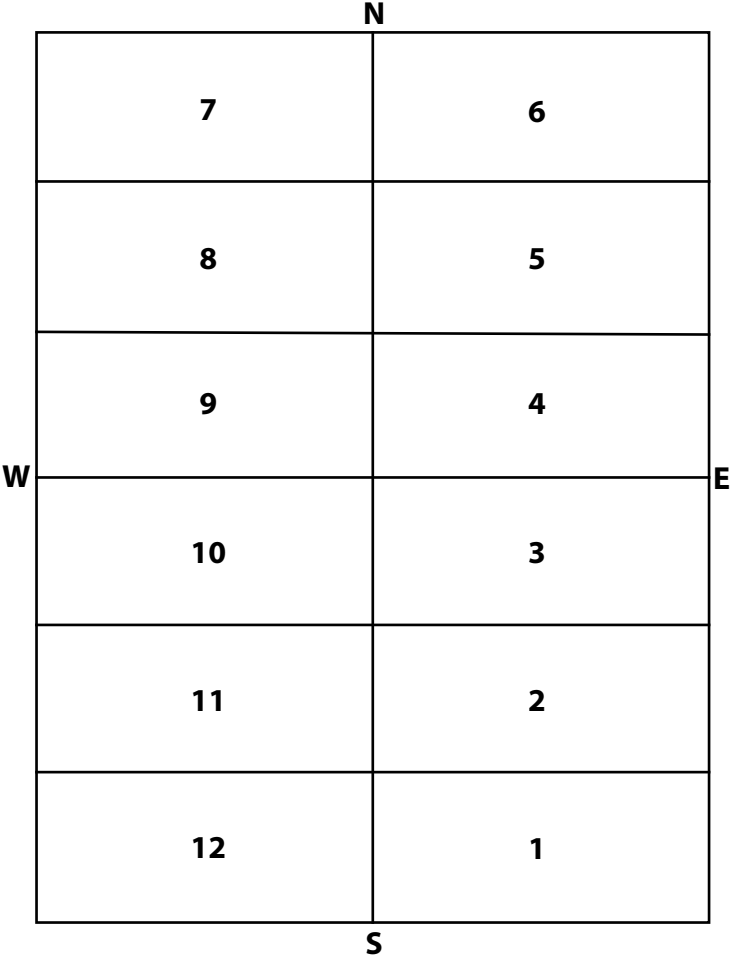

**OWNER** #1-3, 10-12: *Philleo, Laura J. S 1/2*

#4-9: *Coulter, John E. N 1/2*

---



---



---

# Highland Cemetery

SEC. 1 BLK. 144 LOT \_\_\_\_\_ SIZE \_\_\_\_\_

INTERMENTS		
NO.	NAME	DATE
1	<i>Pullen, Catherine (b. 1841)</i>	<i>9 Jun 1895 11 Jun 1895</i>
2	<i>Polk, William M. (b. 1811)</i>	<i>9 Apr 1888 9 Apr 1888</i>
3	<i>Polk, William A. (b. 22 Sep 1851)</i>	<i>6 Oct 1900 7 Oct 1900</i>
4	<i>Polk, Mary A. Smarsh (b. ?????)</i>	<i>22 Feb 1929 23 Feb 1929</i>
5		
6		
7		
8		
9		
10		
11		
12		

		N	
	7		6
	8		5
	9		4
W			E
	10		3
	11		2
	12		1
		S	

OWNER *Polk, W.A.*  
 \_\_\_\_\_  
 \_\_\_\_\_  
 \_\_\_\_\_

# Highland Cemetery

SEC. 1 BLK. 145 LOT \_\_\_\_\_ SIZE \_\_\_\_\_

INTERMENTS		
NO.	NAME	DATE
1	<i>Bonham, Charles Wilson (b. 3 Nov 1873)</i>	4 Feb 1948 7 Feb 1948
2	<i>Bonham, Ida Florence (b. 15 Jul 1874)</i>	15 Feb 1956 17 Feb 1956
3	<i>Giles, John Thomas (b. 16 Feb 1850)</i>	3 Feb 1933 4 Feb 1933
4	<i>Giles, Margaret Allen (b. 6 Aug 1850)</i>	9 Jul 1925 11 Jul 1925
5	<i>Giles, Nellie J. (b. 1885)</i>	8 Dec 1887 8 Dec 1887
6	<i>Giles, Nannie (b. ????)</i>	24 Feb 1887 24 Feb 1887
7	<i>Feierabend, Carl F. (b. 4 Dec 1874)</i>	7 Oct 1942 9 Oct 1942
8	<i>Feierabend, Dorothea Sophia (b. 16 Aug 1877)</i>	12 Dec 1955 15 Dec 1955
9		
10	<i>Schunke, Marie J. (b. 1864)</i>	1953 21 Oct 1953
11	<i>Schunke, Oscar G. (b. 1862)</i>	1948 10 Jul 1948
12		

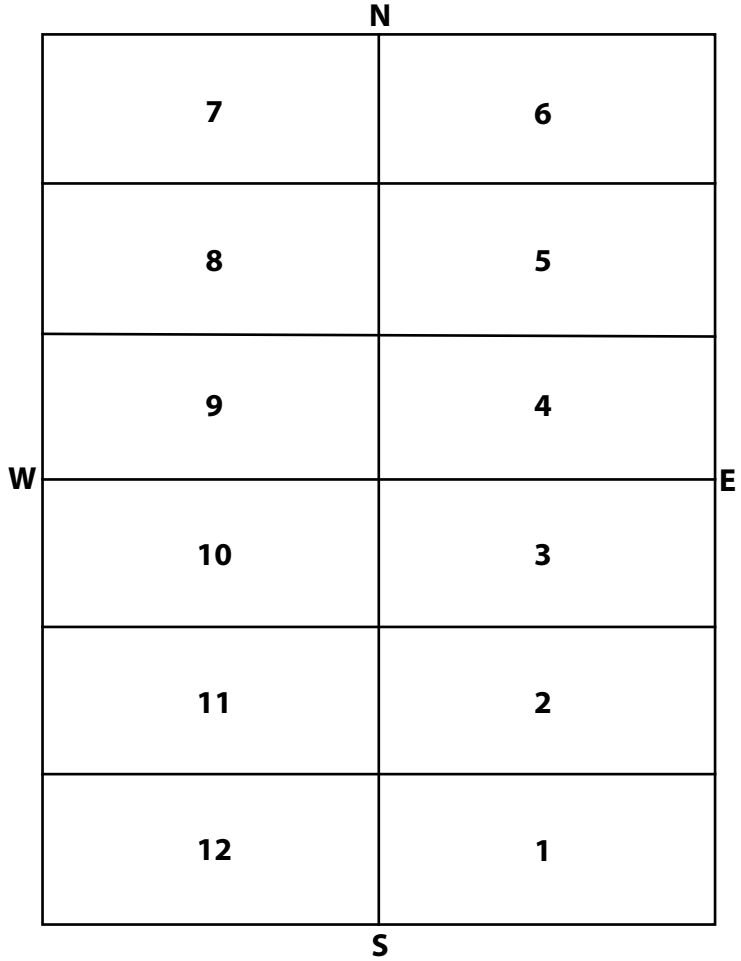

- OWNER** #1-2: Bonham, Mr. & Mrs. Charles from Giles, J.T.
- #3-6: Giles, J.T. E 1/2
- #7-9: Feierabend, Mrs. Carl NW 1/4
- #10-11: Schunke, Marie

# Highland Cemetery

SEC. 1    BLK. 146    LOT \_\_\_\_\_    SIZE \_\_\_\_\_

INTERMENTS		
NO.	NAME	DATE
1		
2		
3	<i>Osborn, Mabel Celia (b. 1 May 1890)</i>	<i>3 Apr 1983 6 Apr 1983</i>
4	<i>Osborn, Howard Larkin (b. 29 Dec 1888)</i>	<i>9 Jan 1973 12 Jan 1973</i>
5		
6		
7	<i>Osborn, Ottie B. (b. 1878)</i>	<i>1887 1887</i>
8	<i>Osborn, Larkin David (b. 10 Aug 1852)</i>	<i>13 Feb 1904 15 Feb 1904</i>
9	<i>Osborn, G. Martha H. (b. Jan 1856)</i>	<i>1938 21 Apr 1938</i>
10	<i>Osborn, George Homer (b. 12 Oct 1891)</i>	<i>Feb 1934 2 Mar 1934</i>
11	<i>Ross, Myrtle Helen (b. 5 Oct 1895)</i>	<i>5 Dec 1966 8 Dec 1966</i>
12		

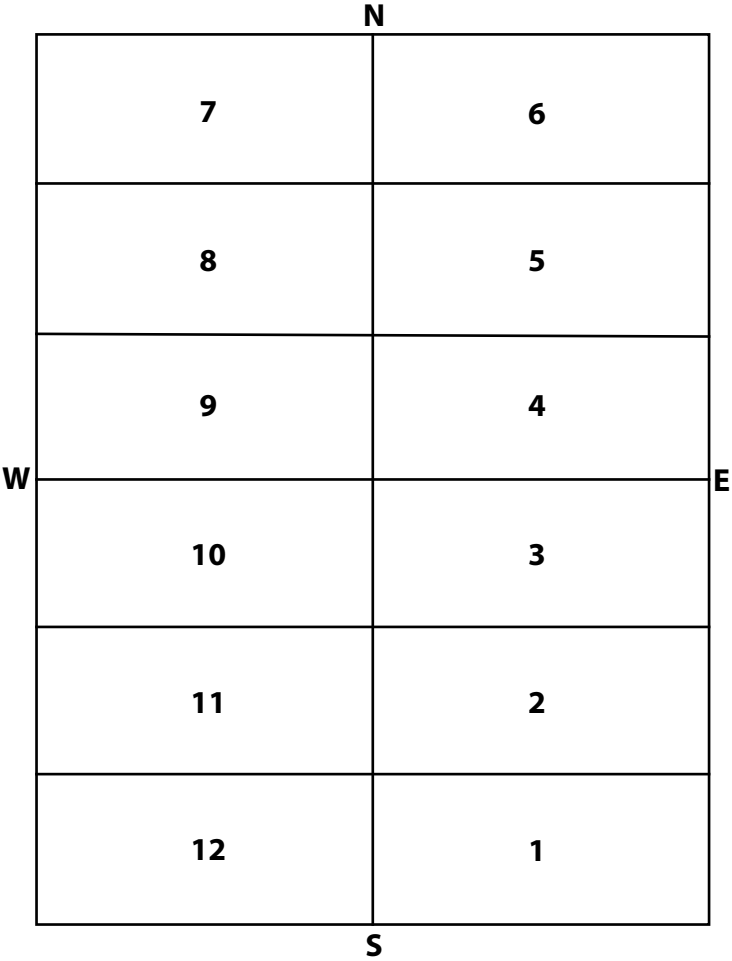

OWNER Osborn, L.D.  
 \_\_\_\_\_  
 \_\_\_\_\_  
 \_\_\_\_\_

# Highland Cemetery

SEC. 1 BLK. 147 LOT \_\_\_\_\_ SIZE \_\_\_\_\_

INTERMENTS		
NO.	NAME	DATE
1	<i>Cozort, William H. (b. 25 Dec 1915)</i>	<i>5 Jan 1996 8 Jan 1996</i>
1A		
1B	<i>Riling, Lester Harold (b. 26 Mar 1912)</i>	<i>21 Aug 1964 24 Aug 1964</i>
2	<i>Cozort, Willetta (b. 1919)</i>	<i>7 Oct 1966 10 Oct 1966</i>
3	<i>Webb, John C. (b. ????)</i>	<i>???? 9 Oct 1942</i>
4	<i>Webb, Helen C. (b. 1870)</i>	<i>1942 17 Jan 1942</i>
5	<i>Goodwin, Mary Belle (b. ????)</i>	<i>???? 21 Feb 1946</i>
6	<i>Goodwin, B.H. (b. ????)</i>	<i>???? 7 Oct 1940</i>
7		
8	<i>Botkin, Fred Bowman (b. 18 Mar 1888)</i>	<i>31 Jul 1888 21 Jul 1888</i>
9	<i>Botkin, Laura Helen (b. 18 Feb 1861)</i>	<i>25 Mar 1888 25 Mar 1888</i>
10		
11	<i>Luening, Maude F. (b. 29 Oct 1885)</i>	<i>19 Aug 1942 21 Aug 1942</i>
12	<i>Luening, William E. (b. 26 Aug 1877)</i>	<i>20 Sep 1969 22 Sep 1969</i>

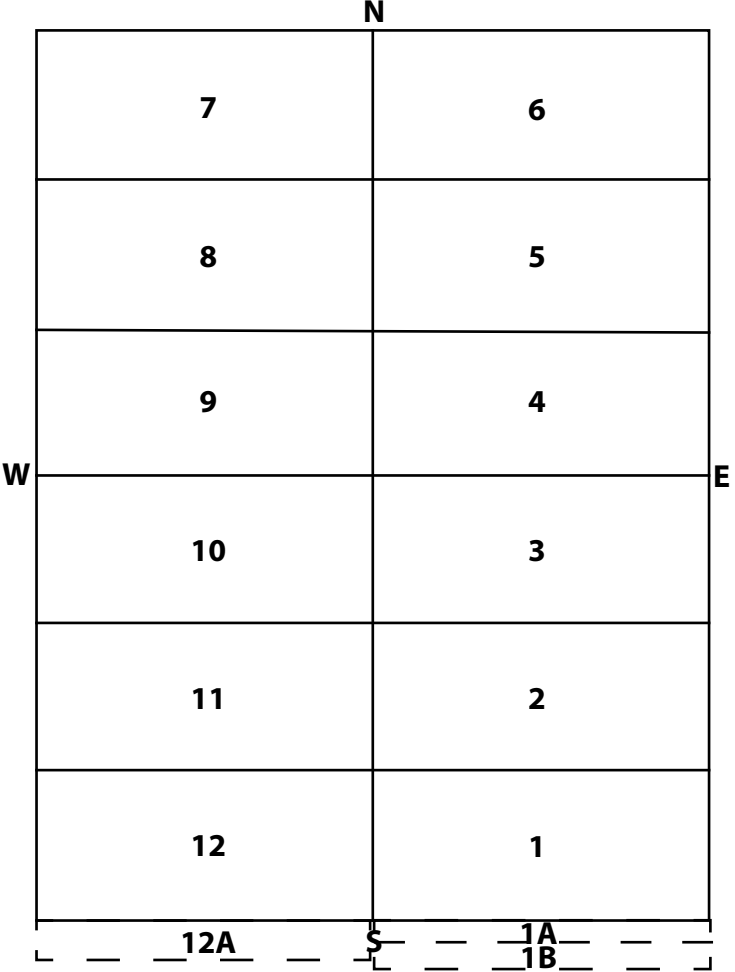

OWNER #1-1B: *Mason, Nellie to cemetery*

---

#2-3: *Webb, Helen C.*

---

#5-6: *Goodwin, Harry A.*

---

#7-9: *Botkin, Ralph W. NW 1/4*

---

#10-12: *Luening, W.F. SW 1/4*



# Highland Cemetery

SEC. 1 BLK. 148 LOT \_\_\_\_\_ SIZE \_\_\_\_\_

INTERMENTS		
NO.	NAME	DATE
1		
2		
3	<i>Noble, John (b. 15 Mar 1874)</i>	<i>6 Jan 1934 6 Jan 1934</i>
4		
5		
6		
7		
8		
9	<i>Kline, Lydia E. (b. 1874)</i>	<i>1960 1 Aug 1960</i>
10	<i>Kline, Robert W. (b. 1867)</i>	<i>1943 10 Aug 1943</i>
11	<i>King, Florence E. (b. 1879)</i>	<i>1942 31 Jul 1942</i>
12		

	N		
	7	6	
	8	5	
	9	4	
W	10	3	E
	11	2	
	12	1	
	S		

**OWNER** #1-3: Noble, John SE 1/4

#9-10: Kline, Lydia

#11-12: Dennis, Mrs. Harold

---

# Highland Cemetery

SEC. 1 BLK. 149 LOT \_\_\_\_\_ SIZE \_\_\_\_\_

INTERMENTS		
NO.	NAME	DATE
1	Schermerhorn, John Sawyer (b. 30 Mar 1881)	3 Aug 1974 7 Aug 1974
2	Schermerhorn, Emma Hinman (b. 12 Oct 1869)	31 Oct 1958 3 Nov 1958
3	Stillwell, Mary F. (b. 15 Aug 1913)	7 May 1990 10 May 1990
4		
5		
6	Nichols, John Chester (b. 13 Jun 1884)	13 Nov 1968 18 Nov 1968
6A	Nichols, Kathryn Schermerhorn (b. 17 Dec 1889)	25 May 1979 30 May 1979
7	Sawyer, Emma Herrick (b. 1 Aug 1833)	4 Jan 1912 6 Jan 1912
7A	Schermerhorn, Bertha (b. 11 Jul 1885)	28 Nov 1972 30 Nov 1972
8	Sawyer, John K. (b. 1831)	31 Dec 1896 2 Jan 1897
9	Sawyer, Charles H. (b. 18 Aug 1863)	18 Mar 1912 20 Mar 1912
10	Res - Sawyer?	
11	Schermerhorn, Frances Lily (b. 1858)	1942 4 Aug 1942
12	Schermerhorn, Edgar (b. 1857)	1938 22 Apr 1938

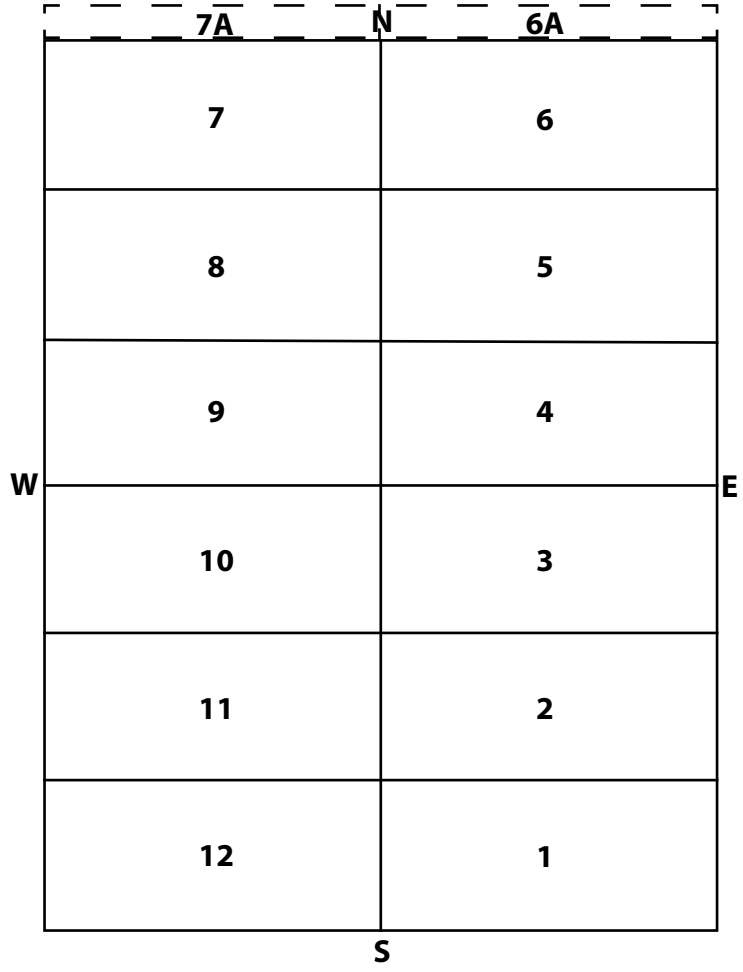

OWNER Sawyer, J.K.  
 \_\_\_\_\_  
 \_\_\_\_\_  
 \_\_\_\_\_

# Highland Cemetery

SEC. 1 BLK. 150 LOT \_\_\_\_\_ SIZE \_\_\_\_\_

INTERMENTS		
NO.	NAME	DATE
1	<i>Shetzley, Minnie F. (b. 10 Jan 1871)</i>	<i>25 May 1908 27 May 1908</i>
2		
3	<i>Shearer, John W. (b. 5 Mar 1846)</i>	<i>2 Mar 1915 3 Mar 1915</i>
4	<i>Shearer, Mahala J. (b. 24 Sep 1847)</i>	<i>24 Jul 1938 26 Jul 1938</i>
5	<i>Shearer, Millage J. (b. 5 Feb 1873)</i>	<i>5 Nov 1952 7 Nov 1952</i>
6	<i>Shearer, Della V. (b. 9 Jan 1879)</i>	<i>27 Mar 1938 29 Mar 1938</i>
7	<i>Shearer, Pauline M. (b. 20 Mar 1904)</i>	<i>27 Jan 2000 29 Jan 2000</i>
8	<i>Shearer, Farrell Kenneth (b. 2 Feb 1903)</i>	<i>20 Jun 1981 24 Jun 1981</i>
9	<i>Shearer, Josephine Opal (b. 16 Dec 1901)</i>	<i>7 Aug 1975 11 Aug 1975</i>
10	<i>Shearer, Dean (b. 4 Sep 1905)</i>	<i>21 Dec 1989 26 Dec 1989</i>
11		
12		

N	
7	6
8	5
9	4
10	3
11	2
12	1
S	

**OWNER** Shearer, E.T.  
To: Farrell and Opal Shearer (17 May 1952)  
To: Dean and Pauline Shearer (8 Aug 1956)

# Highland Cemetery

SEC. 1 BLK. 151 LOT \_\_\_\_\_ SIZE \_\_\_\_\_

## INTERMENTS

NO.	NAME	DATE
1	Barwise, Asa L. (b. 24 Nov 1837)	6 Nov 1898 3 May 1911
2	Barwise, Cora E. (b. 21 Jan 1842)	9 May 1911 11 May 1911
3	Barwise, Maude (b. 4 Feb 1879)	17 Jan 1881 3 May 1911
4	Barwise, Joseph Alexander (b. 12 Nov 1884)	10 Mar 1917 12 Mar 1917
5	Stewart, Ida B. (b. 5 Jun 1879)	5 Jul 1959 6 Jul 1959
6	Stewart, Joseph Henry (b. 16 Jan 1875)	24 Apr 1924 26 Apr 1924
7		
8		
9		
10		
11		
12		

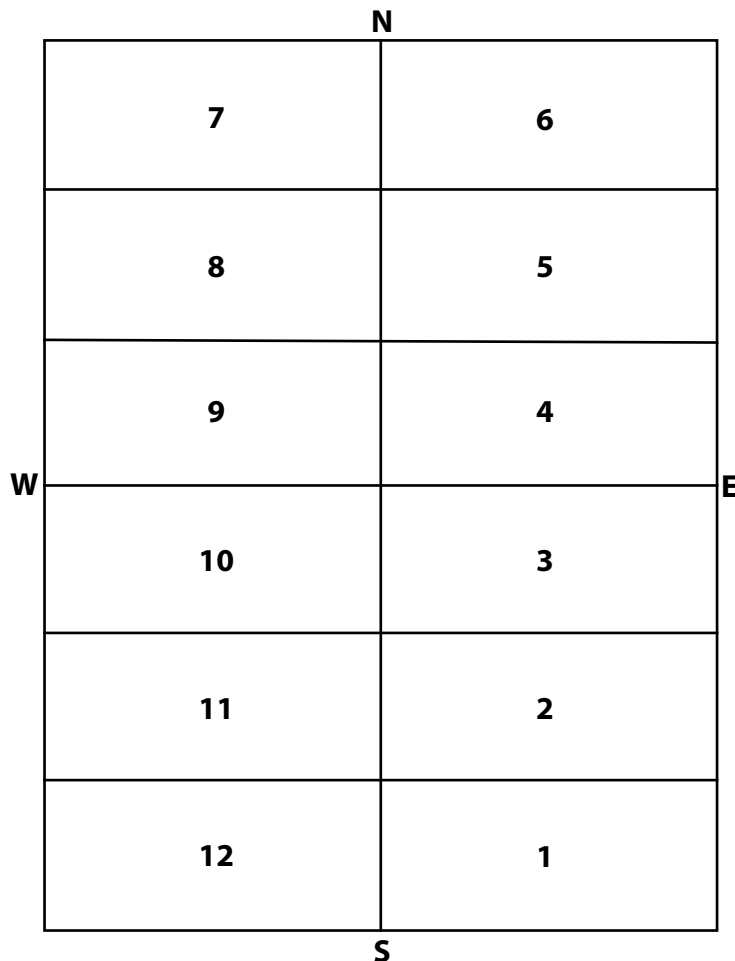

OWNER McLean, Mrs. B.F.

---



---



---

# Highland Cemetery

SEC. 1 BLK. 152 LOT \_\_\_\_\_ SIZE \_\_\_\_\_

## INTERMENTS

NO.	NAME	DATE
1		
2		
3		
4	<i>Simmons, Gaile (b. 1 Mar 1877)</i>	<i>11 Feb 1961 13 Feb 1961</i>
5	<i>Coffey, Bruce Worthington (b. 23 Apr 1907)</i>	<i>5 Jul 1915 6 Jul 1915</i>
6	<i>Campbell, Fannie (b. 6 Aug 1873)</i>	<i>7 Apr 1879 7 Apr 1879</i>
7	<i>Campbell, Margaret (b. 18 Oct 1849)</i>	<i>3 Aug 1948 5 Aug 1948</i>
7A	<i>Reynolds, Maude C. (b. 12 Jul 1872)</i>	<i>13 Nov 1975 17 Nov 1975</i>
8	<i>Campbell, Charles Butler (b. 5 Oct 1845)</i>	<i>22 Jan 1931 24 Jan 1931</i>
9	<i>Simmons, Calvin Durward (b. 21 Feb 1878)</i>	<i>12 Nov 1928 14 Nov 1928</i>
10		
11		
12		

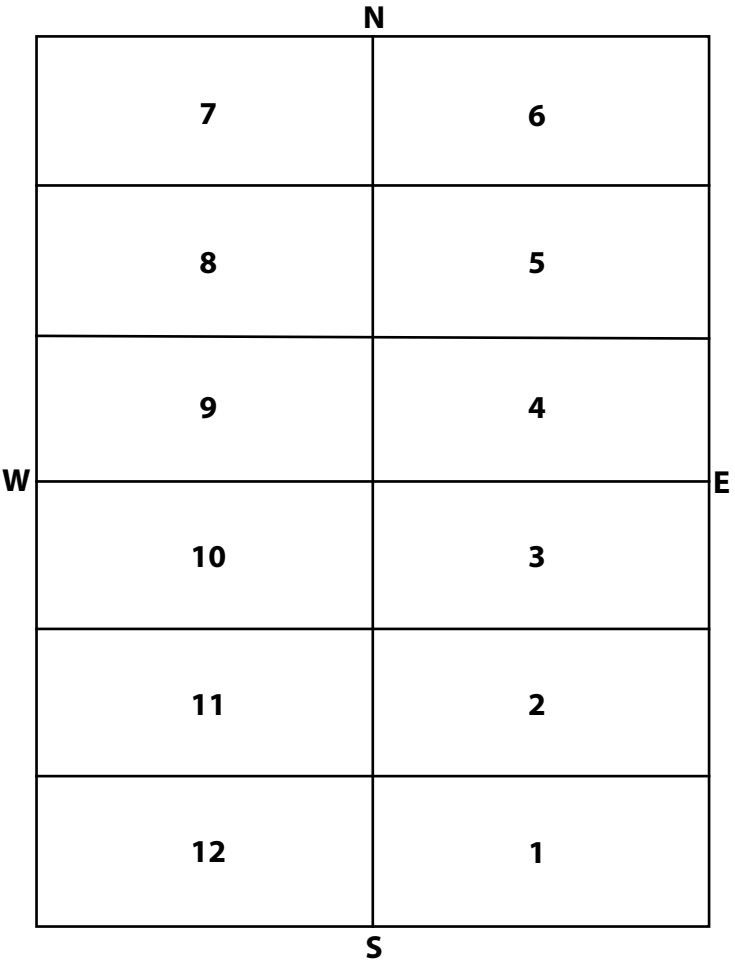

OWNER #1-3, 10-12: Cramphin, L.C. S 1/2  
 #4-9: Campbell, C.B. N 1/2  
 #7A: Reynolds, C.C. (16 Aug 1961) 12406 Trail Oaks, OKC

# Highland Cemetery

SEC. 1 BLK. 153 LOT \_\_\_\_\_ SIZE \_\_\_\_\_

INTERMENTS		
NO.	NAME	DATE
1	Alice, S.C. (b. ????)	???? 1872
2	Stuckey, Infant (b. ????)	10 Mar 1896 10 Mar 1896
2	Shaver, Karon Lee (b. ????)	???? 13 May 1944
3	Stuckey, Infant (b. ????)	1 Oct 1912 2 Oct 1912
3A	Wilson, Dale (b. 25 Mar 1905)	21 Apr 1905 22 Apr 1905
4		
5		
6		
7	Brown, Virgil Nelson (b. 19 Oct 1916)	28 Dec 1927 31 Dec 1927
8		
9		
10	Stuckey, Jerry Frederick (b. 1 Jan 1892)	16 May 1958 19 May 1958
11	Stuckey, Jane Elizabeth (b. 3 Apr 1857)	10 Feb 1934 12 Feb 1934
12	Stuckey, Joseph Lewis (b. 15 Nov 1853)	4 Dec 1915 6 Dec 1915

N	
7	6
8	5
9	4
10	3
	3A
11	2
12	1
S	

OWNER #1-3A: Stuckey, J.L. SE 1/4  
#4-6: Parmenter, L. NE 1/4  
#7-9: Brown, V.D. NW 1/4  
#10-12: Stuckey, J.S. SW 1/4

# Highland Cemetery

SEC. 1 BLK. 154 LOT \_\_\_\_\_ SIZE \_\_\_\_\_

INTERMENTS		
NO.	NAME	DATE
1	<i>Doney, Flora M. (b. ?????)</i>	<i>21 Dec 1877 21 Dec 1877</i>
2		
3	<i>Doney, R.E. (b. 20 Feb 1870)</i>	<i>3 Nov 1893 4 Nov 1893</i>
4		
5		
6		
7		
8		
9		
10	<i>Doney, A. Pearl (b. 16 Jul 1883)</i>	<i>28 Jun 1901 29 Jun 1901</i>
11	<i>Doney, Mathias M. (b. 18 Sep 1845)</i>	<i>2 Jan 1911 5 Jan 1911</i>
12	<i>Doney, Cinderella (b. 1 Mar 1844)</i>	<i>23 Dec 1915 24 Dec 1915</i>

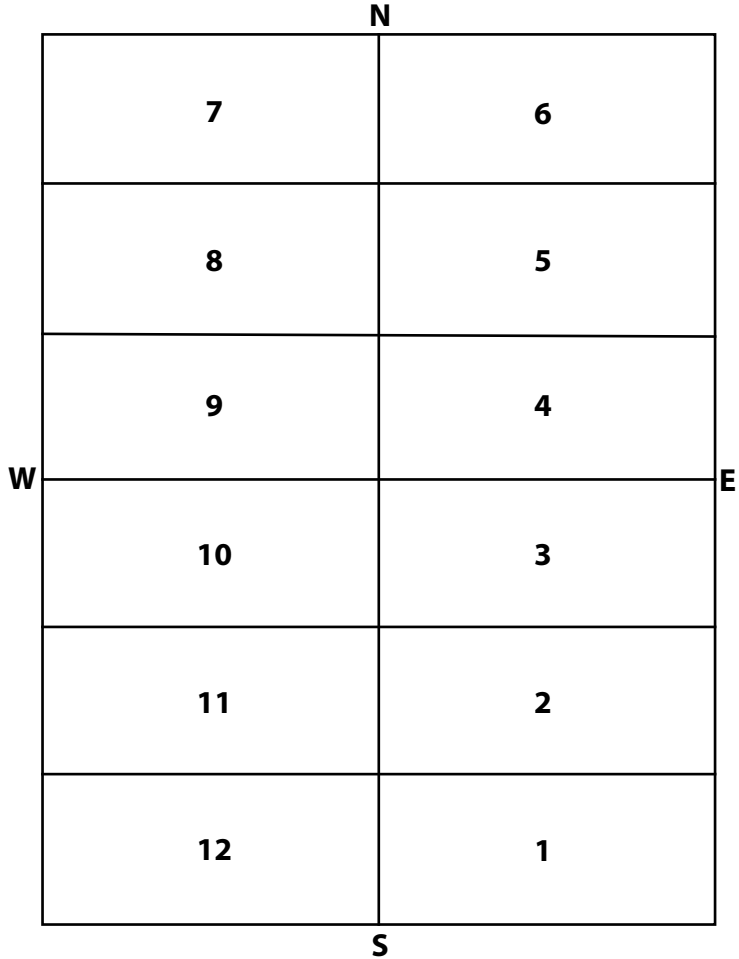

OWNER #1-3, 10-12: Doney, M.M. S 1/2  
#4-9: Edwards, W. N 1/2 (3 Sep 1876)

# Highland Cemetery

SEC. 1 BLK. 155 LOT \_\_\_\_\_ SIZE \_\_\_\_\_

## INTERMENTS

NO.	NAME	DATE
1		
2		
3		
4	Loper, Sarah I. (b. 23 Feb 1841)	8 Feb 1908 10 Feb 1908
5		
6		
7		
8		
9		
10		
11	Loper, Benny F. (b. 17 Nov 1853) - ashes	13 Nov 1927 17 Sep 1928
12		
	Dennis, George W. (b. 31 May 1841)	19 Sep 1876 1876

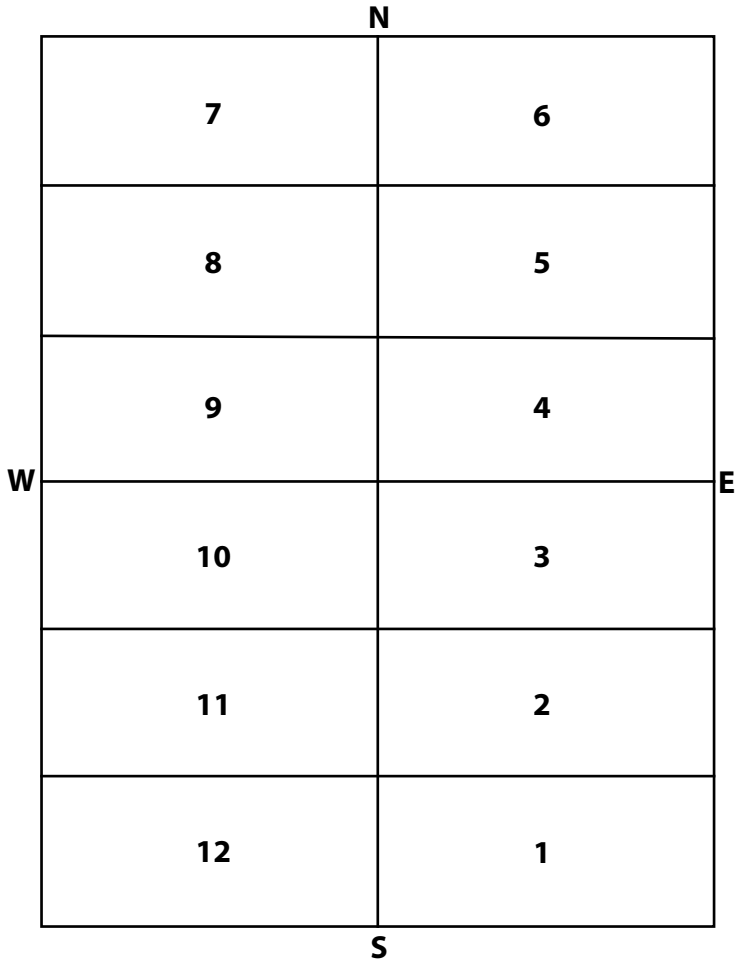

OWNER Dennis, S.I.

---



---



---



# Highland Cemetery

SEC.   1   BLK.   156   LOT \_\_\_\_\_ SIZE \_\_\_\_\_

INTERMENTS		
NO.	NAME	DATE
1		
1A	<i>Cummings, Oscar (b. 22 Oct 1889)</i>	<i>30 Nov 1962 5 Dec 1962</i>
2		
3		
4	<i>Kelso, Elizabeth J.A. (b. ?????)</i>	<i>19 Feb 1922 20 Feb 1922</i>
5	<i>Abbott, Thomas C. (b. 15 Apr 1838)</i>	<i>9 Sep 1905 11 Sep 1905</i>
6	<i>Abbott, Elizabeth J. (b. 1837)</i>	<i>15 Jan 1890 1890</i>
7	<i>Abbott, Addie Elizabeth (b. 18 Nov 1868)</i>	<i>1 Apr 1958 3 Apr 1958</i>
8	<i>Abbott, Thomas (b. 30 Nov 1867)</i>	<i>28 Jun 1941 1 Jul 1941</i>
9		
10		
11	<i>Abbott, Adelia May (b. 1875)</i>	<i>1954 1 Apr 1954</i>
12	<i>Abbott, Jack (b. 1867)</i>	<i>1938 5 Jan 1938</i>

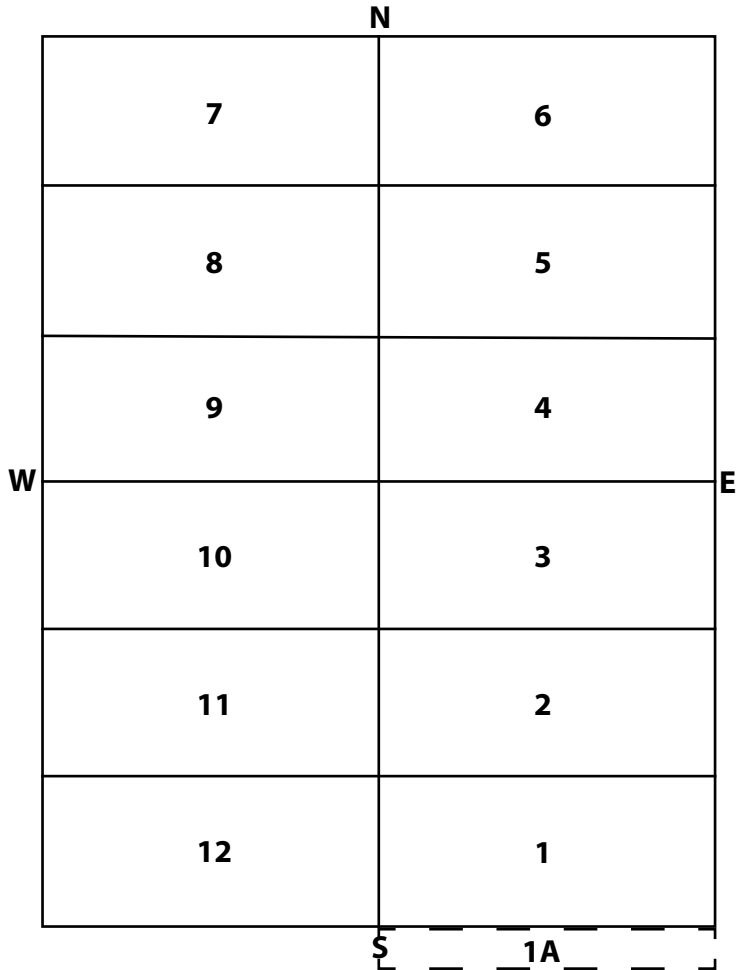

**OWNER** *Abbott, John and Ladies Aid Society*

*#4: Elizabeth J.A. Kelso removed to Maple Grove*

---



---



---

# Highland Cemetery

SEC. 1 BLK. 157 LOT \_\_\_\_\_ SIZE \_\_\_\_\_

## INTERMENTS

NO.	NAME	DATE
1		
2	<i>Ford, Hervey L. (b. 21 Aug 1886)</i>	<i>5 Jan 1913 8 Jan 1913</i>
3	<i>Ford, Horatio N. (b. 17 Jan 1845)</i>	<i>???? 10 Mar 1925</i>
4	<i>Ford, Eliza Jane (b. Oct 1853)</i>	<i>17 Feb 1932</i>
5		
6		
7		
8	<i>Ford, Georgie A. (b. 1868)</i>	<i>4 Feb 1886 4 Feb 1886</i>
9	<i>Ford, Ray S. (b. ?????)</i>	<i>3 Jun 1886 1886</i>
10		
11	<i>Lee, Sylvia Ann (b. ?????)</i>	<i>17 Jun 1907 20 Nov 1907</i>
12	<i>Lee, Sarah T. (b. 6 Dec 1801)</i>	<i>1 Apr 1887 2 Apr 1887</i>

N	
7	6
8	5
9	4
10	3
11	2
12	1
S	

W \_\_\_\_\_ E

OWNER Ford, E.P.  
\_\_\_\_\_  
\_\_\_\_\_  
\_\_\_\_\_

# Highland Cemetery

SEC. 1 BLK. 158 LOT \_\_\_\_\_ SIZE \_\_\_\_\_

## INTERMENTS

NO.	NAME	DATE
1	<i>Angelo, Samuel (b. 10 Dec 1853)</i>	<i>18 Nov 1927 21 Nov 1927</i>
2	<i>Angelo, Martha Ann "Mattie" (b. Jul 1859)</i>	<i>18 Oct 1932 20 Oct 1932</i>
3	<i>Angelo, William Okenas "Billy" (b. 4 Nov 1886)</i>	<i>23 Oct 1929 26 Oct 1929</i>
4		
5	<i>Stephens, Ralph (b. 17 Oct 1884)</i>	<i>11 May 1907 13 May 1907</i>
6	<i>Stephens, Leslie (b. 18 Nov 1882)</i>	<i>16 Feb 1908 19 Feb 1908</i>
7	<i>Angelo, Lawrence Alpheus "Jack" (b. 27 Oct 1889)</i>	<i>12 Dec 1937 14 Dec 1937</i>
8		
9		
10	<i>Ask, Lucinda Kathryn (b. 1857)</i>	<i>1935 5 Aug 1935</i>
11	<i>Ask, Justus Albertson "Jesse" (b. 15 Feb 1845)</i>	<i>25 Jan 1907 26 Jan 1907</i>
12		

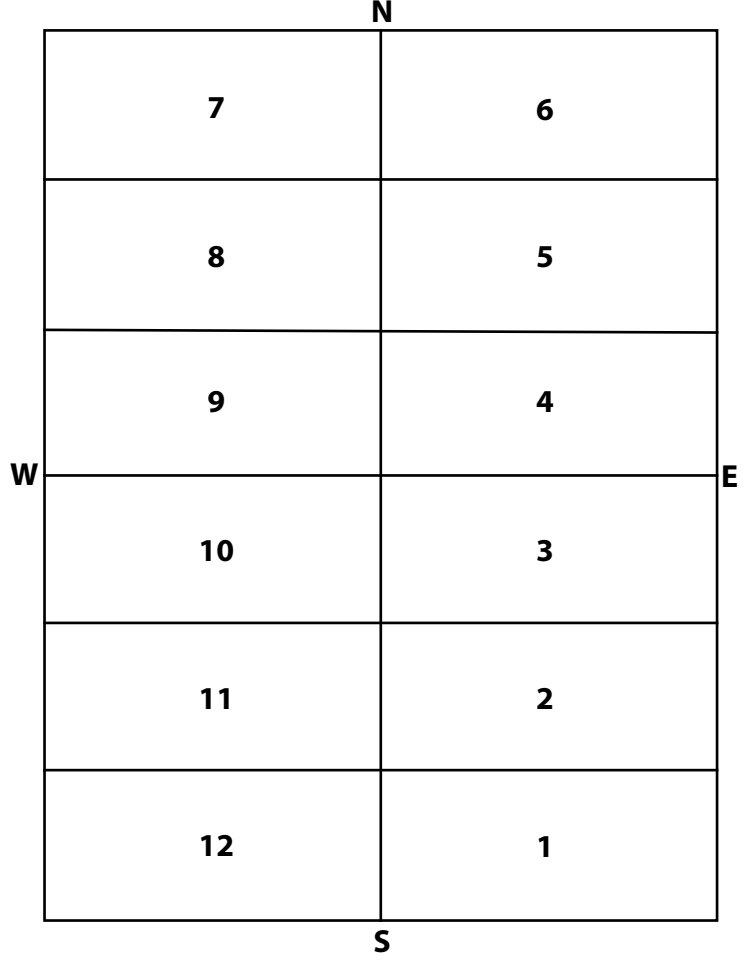

**OWNER** #1-6: Stephens E 1/2  
#7-12: Ask, Jesse W 1/2

---

---

---

# Highland Cemetery

SEC. 1    BLK. 159    LOT \_\_\_\_\_    SIZE \_\_\_\_\_

INTERMENTS		
NO.	NAME	DATE
1		
2	Hotchkiss, W.S. (b. ????)	21 Aug 1909 24 Aug 1909
3		
4		
5		
6		
7		
8		
9		
10		
11		
12		

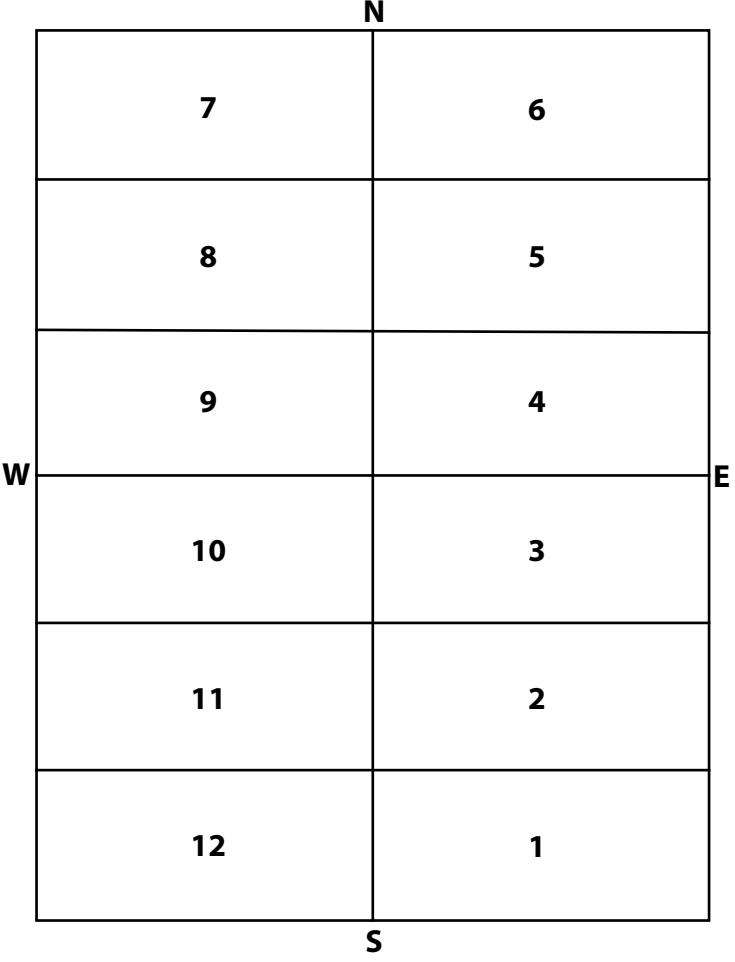

OWNER Smith, W.D.  
 \_\_\_\_\_  
 \_\_\_\_\_  
 \_\_\_\_\_

